

eduard



Tornado ECR 1/48

Stavební návod

Limited Edition

11154-NAVI

ATTENTION



UPOZORNĚNÍ



ACHTUNG



ATTENTION



注意



Carefully read instruction sheet before assembling. When you use glue or paint, do not use near open flame and use in well ventilated room. Keep out of reach of small children. Children must not be allowed to suck any part, or pull vinyl bag over the head.



Před započítím stavby si pečlivě prostudujte stavební návod. Při používání barev a lepidel pracujte v dobře větrané místnosti. Lepidla ani barvy nepoužívejte v blízkosti otevřeného ohně. Model není určen malým dětem, mohlo by dojít k požití drobných dílů.

INSTRUCTION SIGNS * INSTR. SYMBOLS * INSTRUKTION SINNBILDEN * SYMBOLES * 記号の説明

OPTIONAL
VOLBABEND
OHNOUTSAND
BROUSITOPEN HOLE
VYVRTAT OTVORSYMETRICAL ASSEMBLY
SYMETRICKÁ MONTÁŽREMOVE
ODŘÍZNOUTREVERSE SIDE
OTOČITAPPLY EDUARD MASK
AND PAINT
POUŽIT EDUARD MASK
NABARVIT

PARTS



DÍLY



TEILE



PIÈCES



部品

PLASTIC PARTS

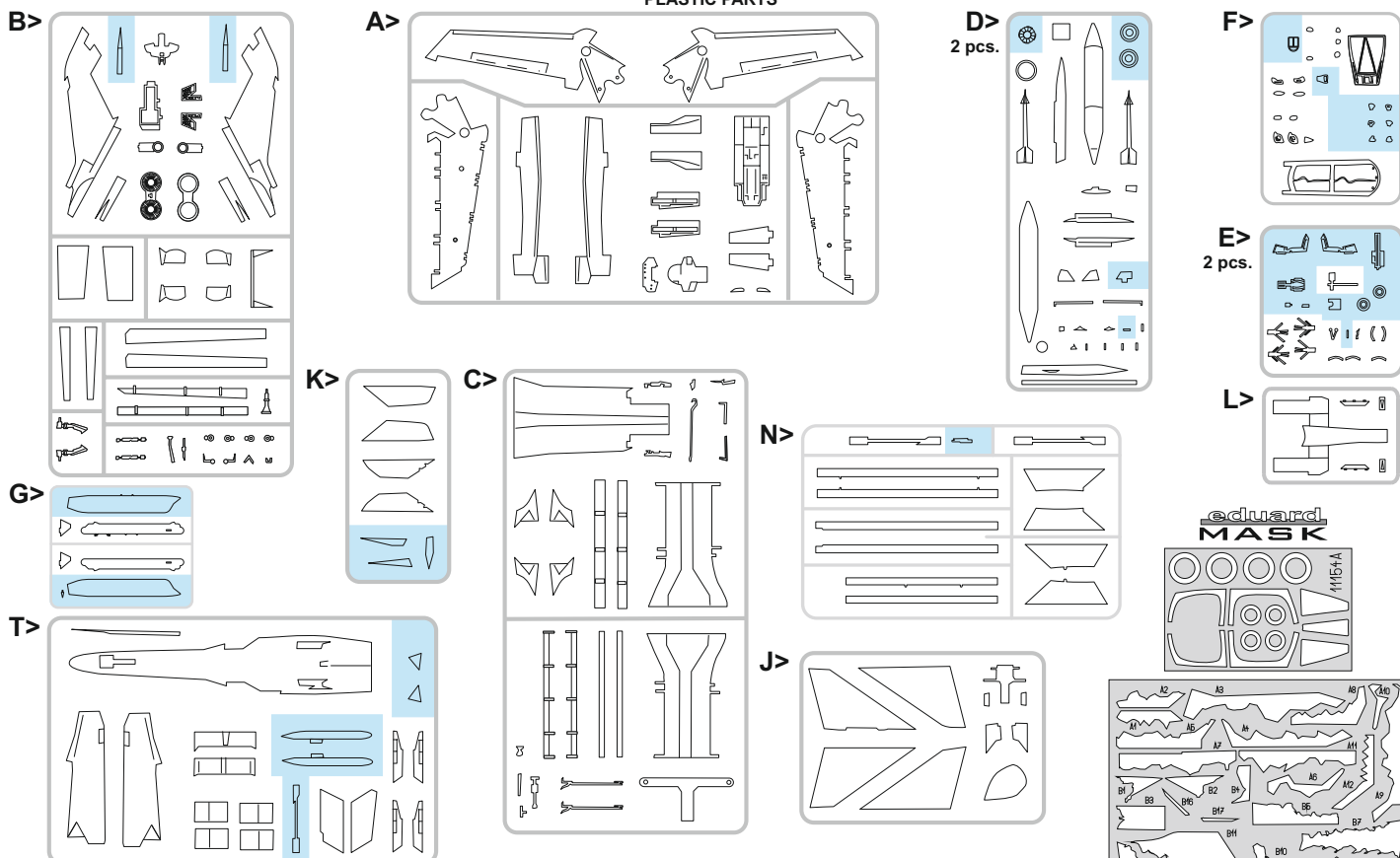

PE - PHOTO ETCHED DETAIL PARTS

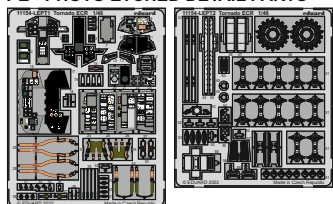

FILM



RP - RESIN PARTS



R1 2pcs.



R2

R3

R4 2pcs.

R5



R6 2pcs.



R7 2pcs.



R8 2pcs.



R9 2pcs.



R10 2pcs.



R11 2pcs.



R15



R16

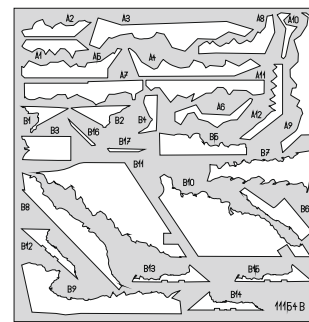

-Parts not for use. -Teile werden nicht verwendet. -Pièces à ne pas utiliser. -Tyto díly nepoužívejte při stavbě. - 使用しない部品

COLOURS



BARVY



FARBEN



PEINTURE



色

GSI Creos (GUNZE)		MISSION MODELS	
AQUEOUS	Mr.COLOR	PAINTS	
H11	C62	MMP-001	FLAT WHITE
H12	C33	MMP-047	FLAT BLACK
H25	C34		SKY BLUE
H44	C51		FLESH
H52	C12	MMP-091	OLIVE DRAB
H77	C137	MMP-040	TIRE BLACK
H90	C47		CLEAR RED
H94	C138		CLEAR GREEN
H301	C301	MMP-099	GRAY
H306	C306	MMP-118	MEDIUM GRAY
H307	C307	MMP-074	GRAY
H308	C308	MMP-073	GRAY
H309	C309	MMP-031	GREEN
H317	C317	MMP-064	GRAY
H323	C323		LIGHT BLUE

GSI Creos (GUNZE)		MISSION MODELS	
AQUEOUS	Mr.COLOR	PAINTS	
H328	C328		BLUE
H331	C331		DARK SEAGRAY
H334	C334	MMP-102	BARLEY GRAY
H337	C337		GRAYISH BLUE
H338	C338	MMP-116	LIGHT GRAY
H401			DARK GRAY
H405	C126		OLIVE GREEN
H413	C113	MMP-090	YELLOW
H421	C121	MMP-052	GREEN
Mr.METAL COLOR		METALLICS	
MC213		MMM-006	STAINLESS
MC214		MMM-001	DARK IRON
MC218		MMM-001	ALUMINIUM
Mr.COLOR SUPER METALLIC		METALLICS	
SM201		MMC-001	SUPER FINE SILVER

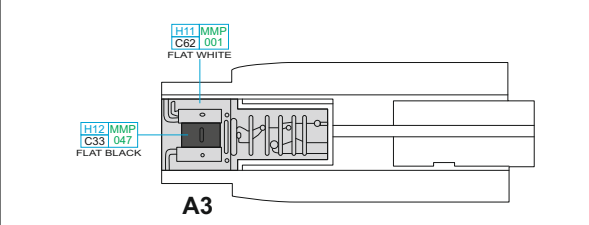
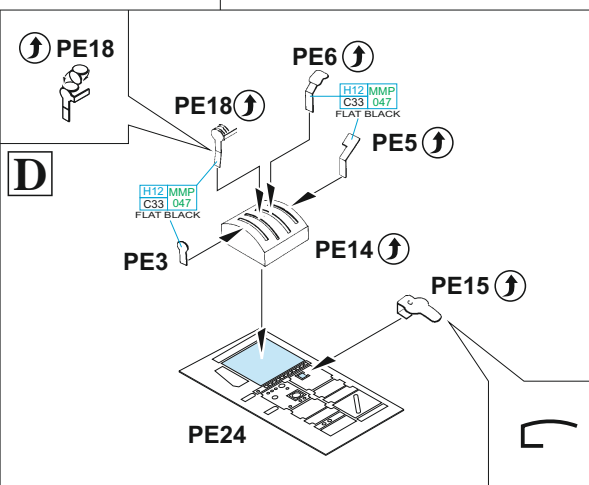
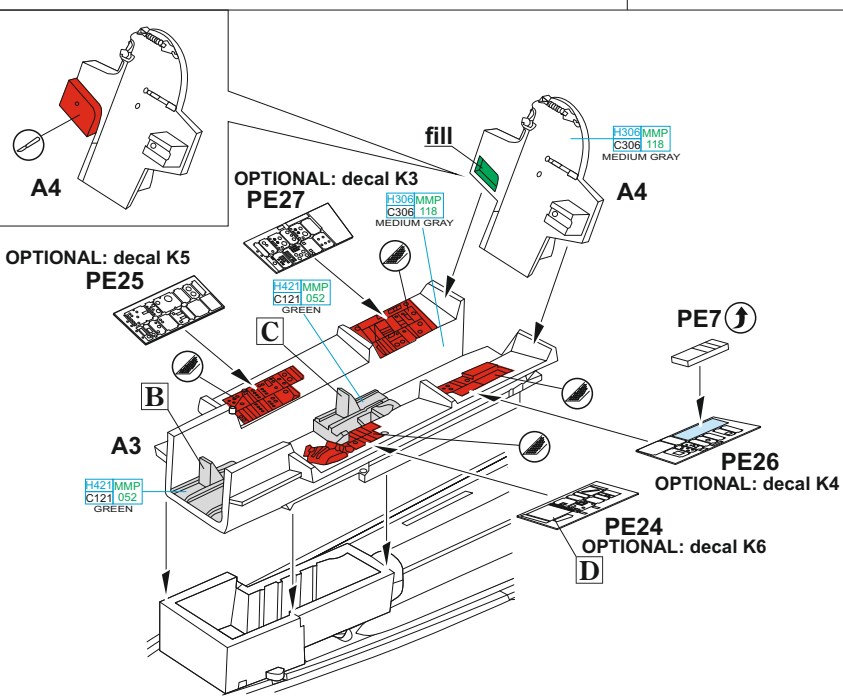
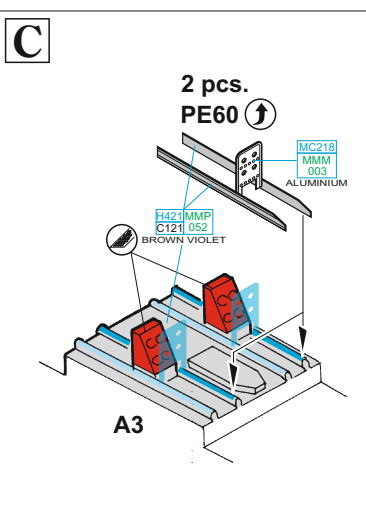
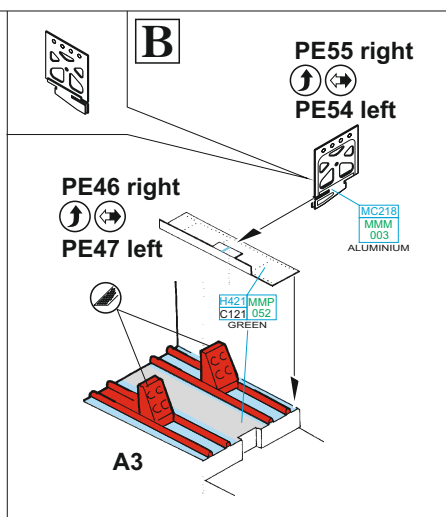
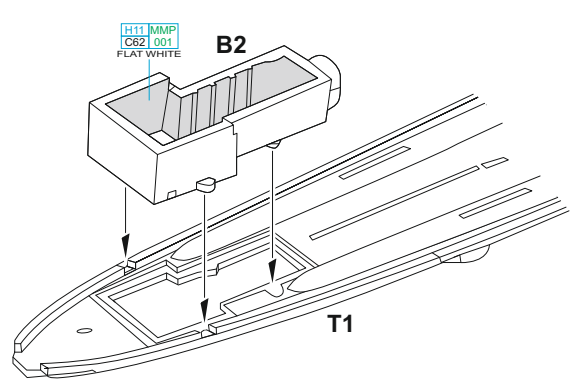
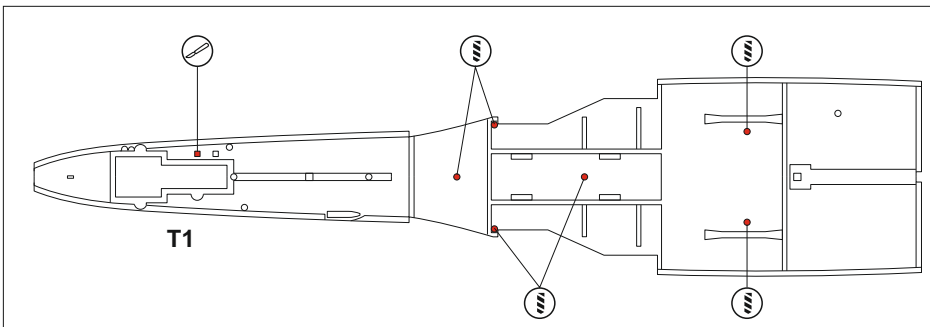
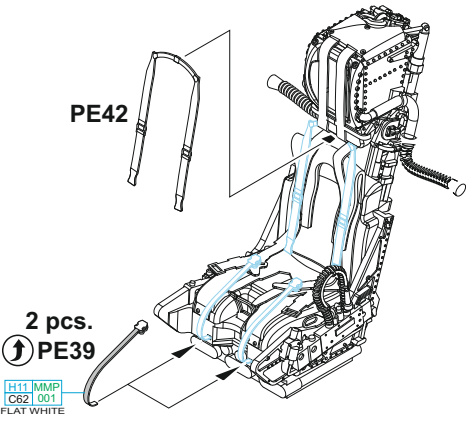
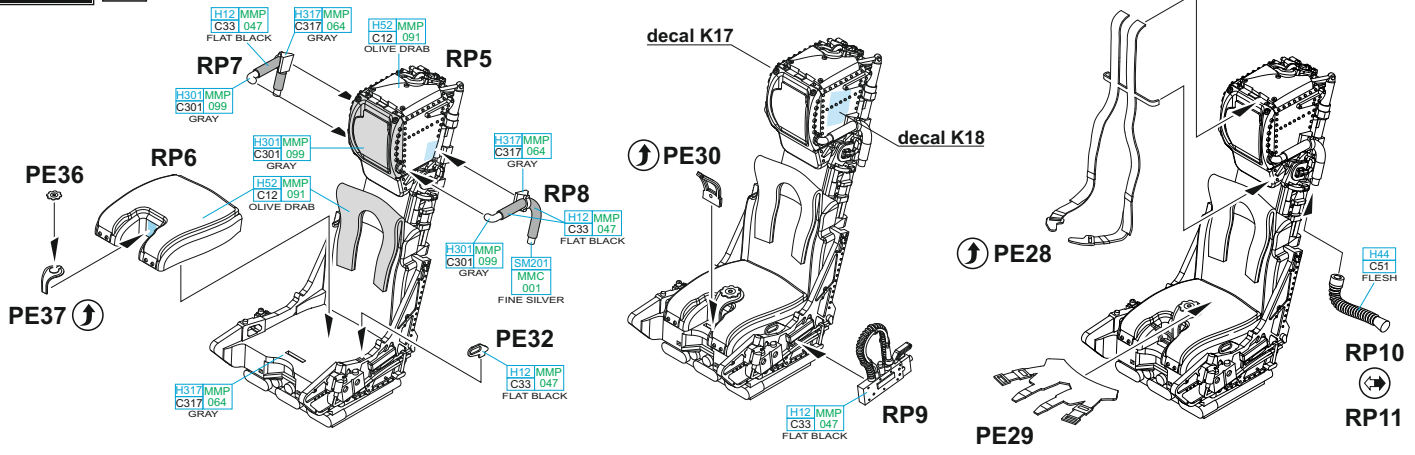

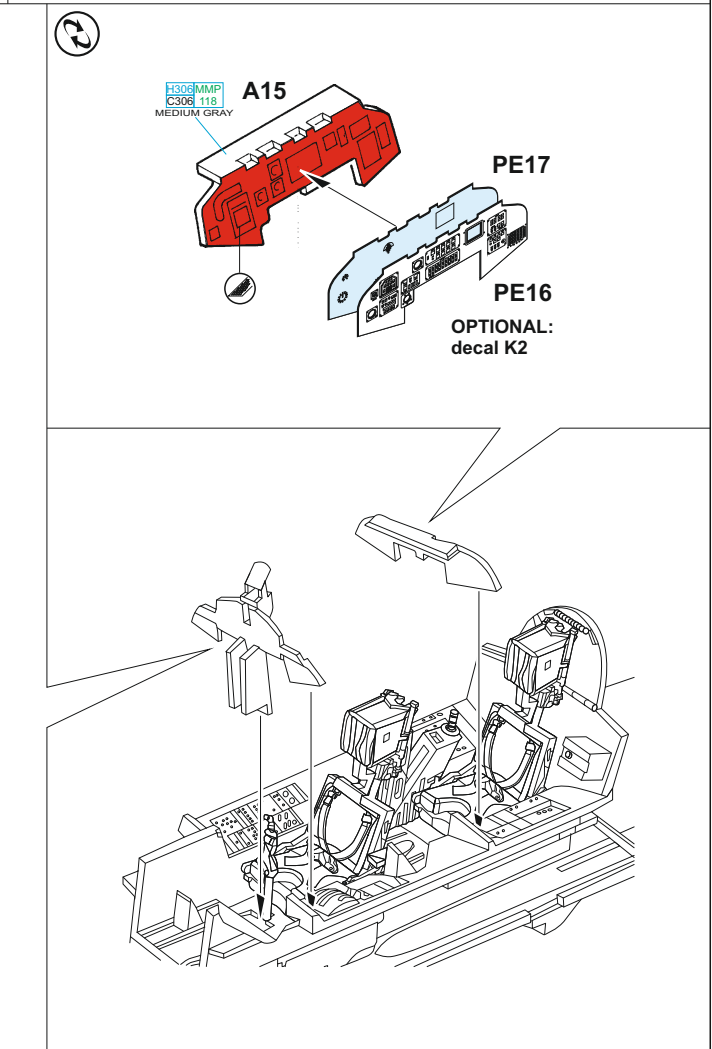
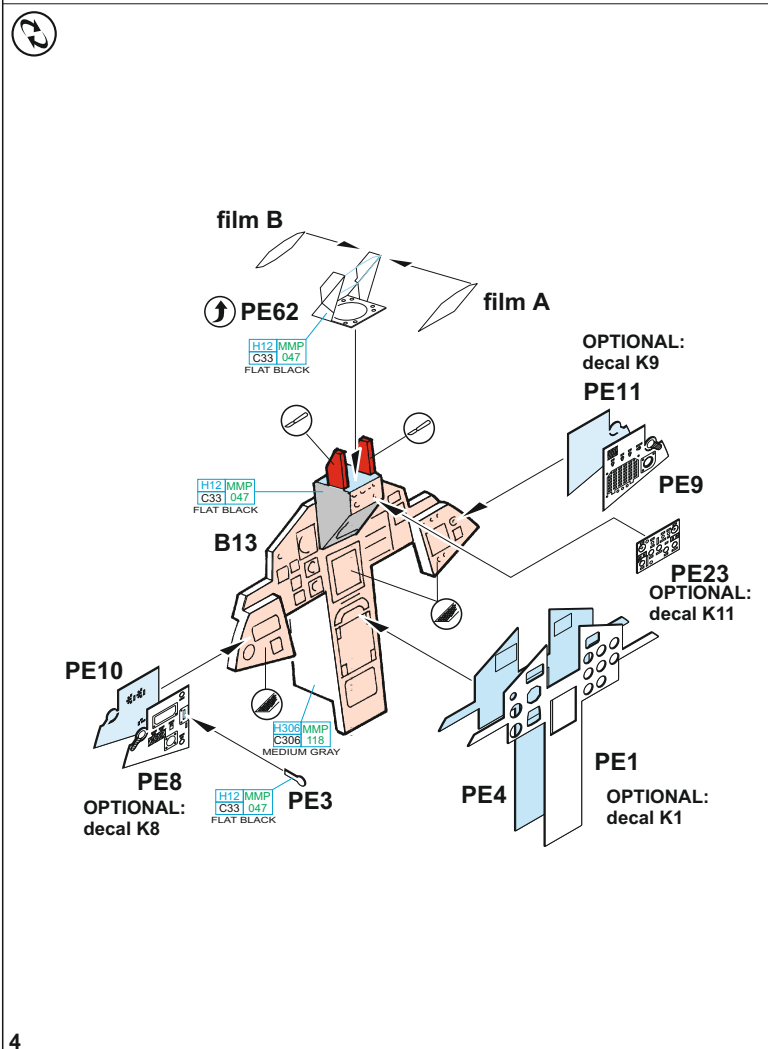
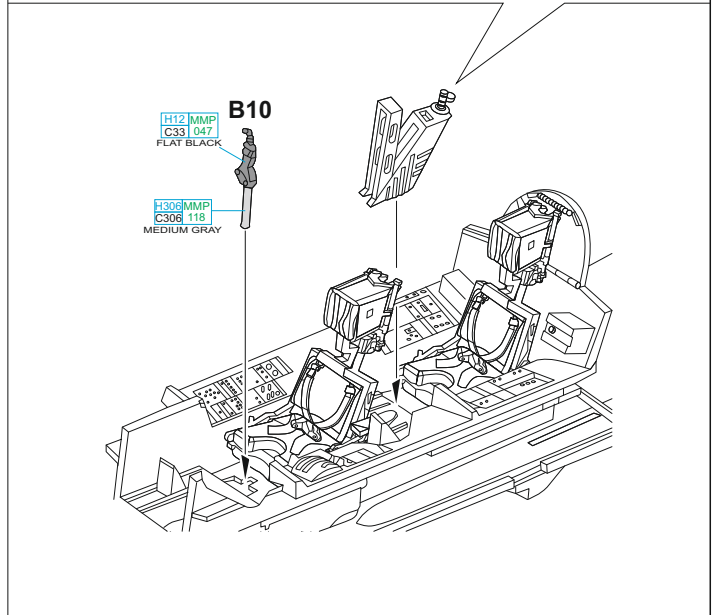
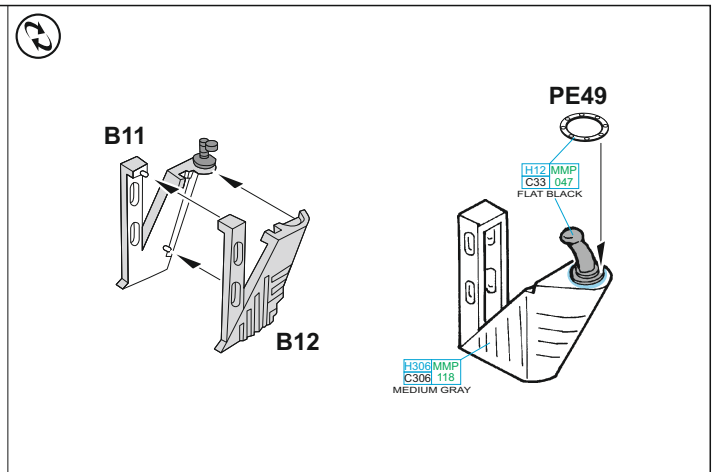
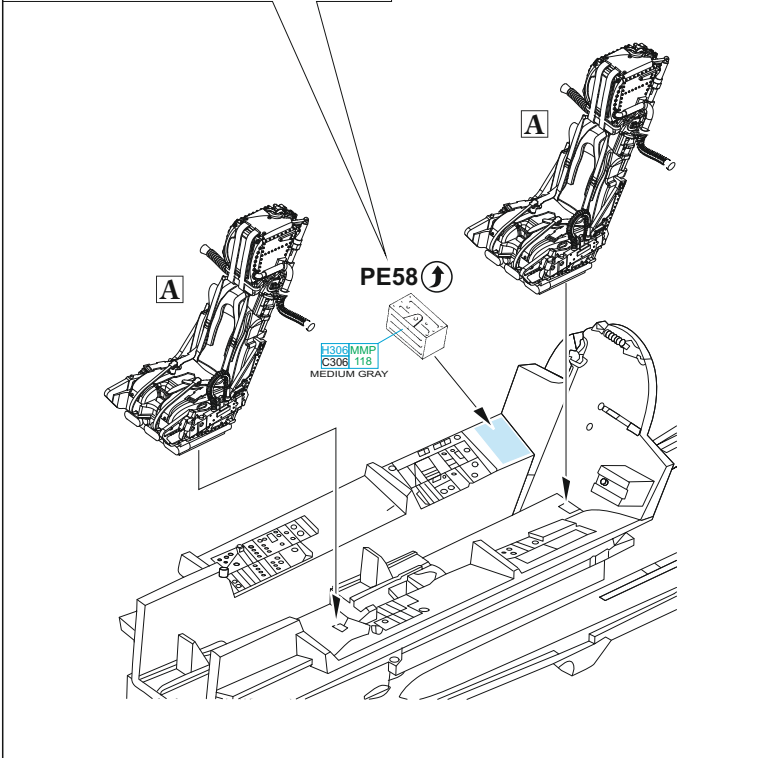
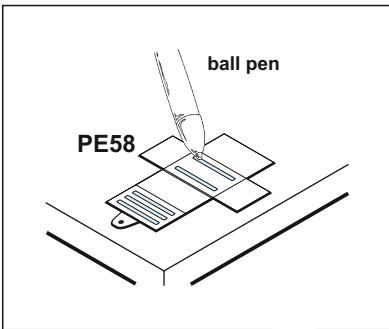

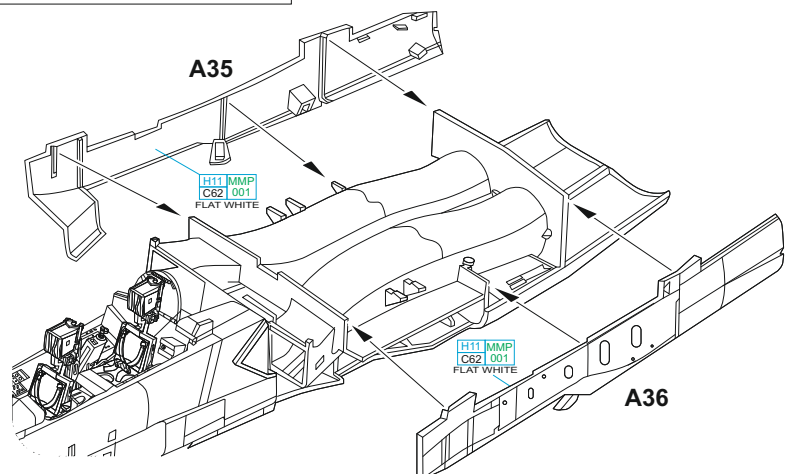
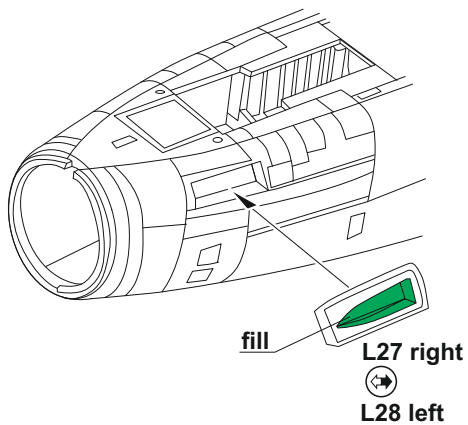
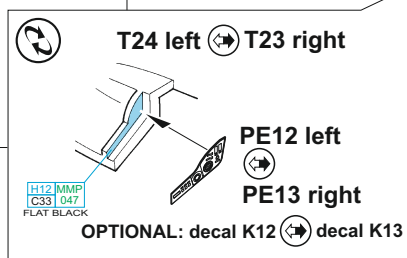
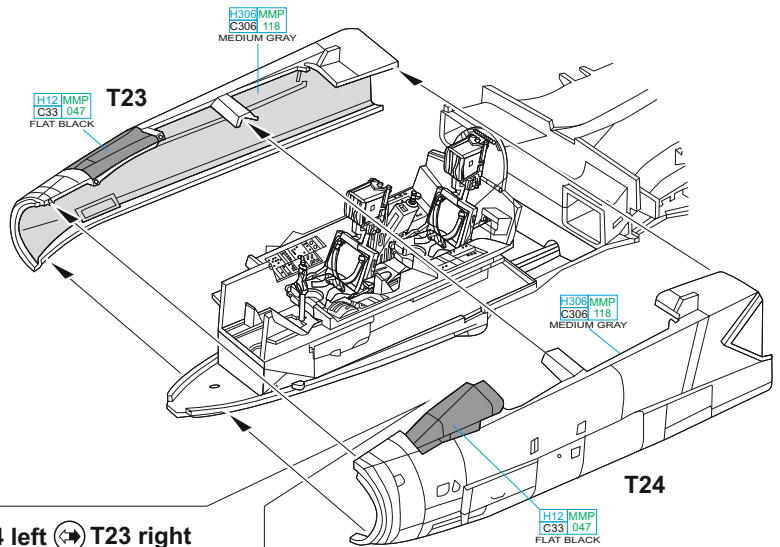
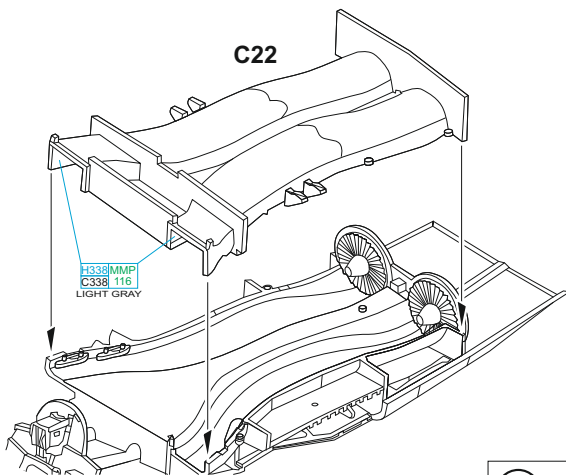
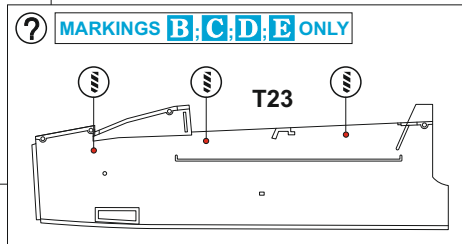
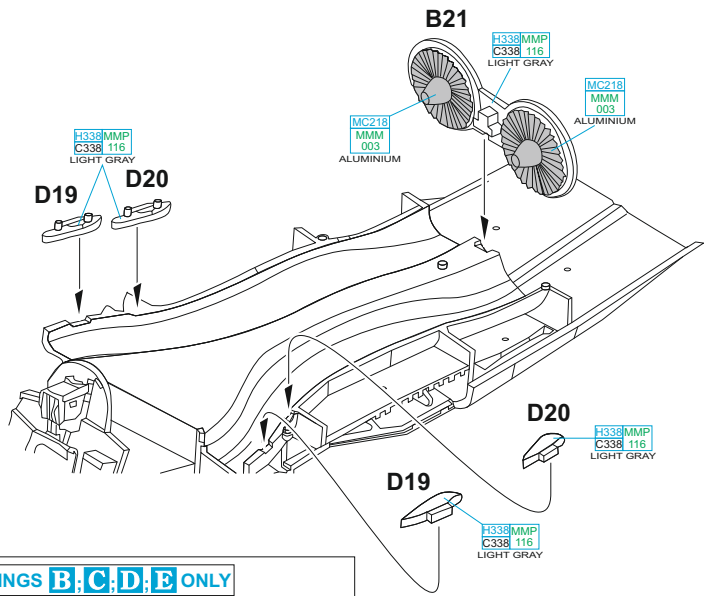
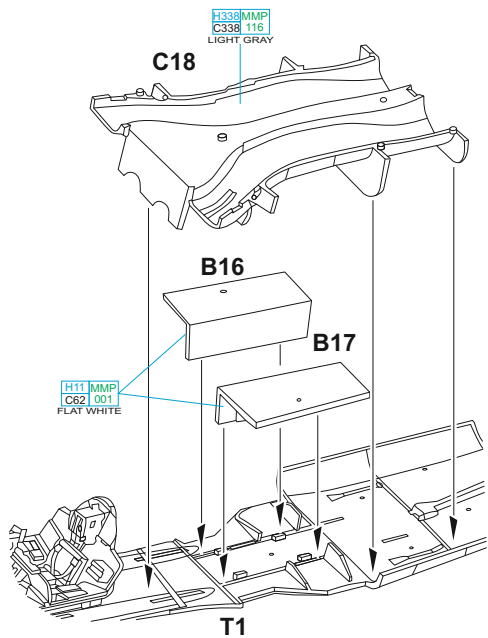

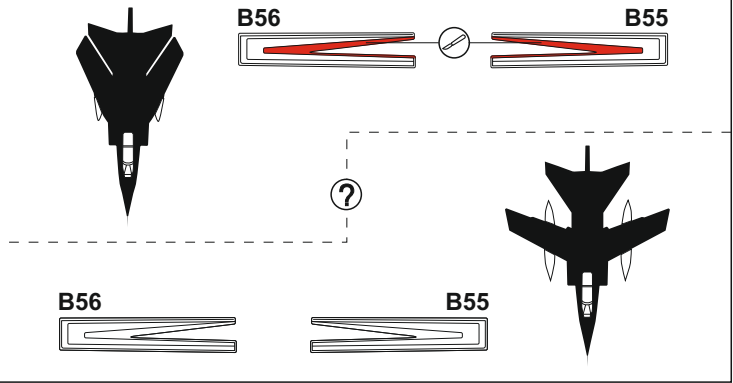
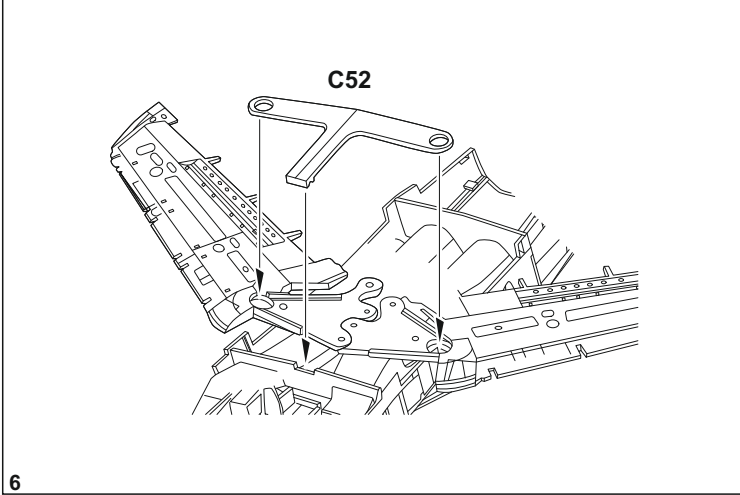
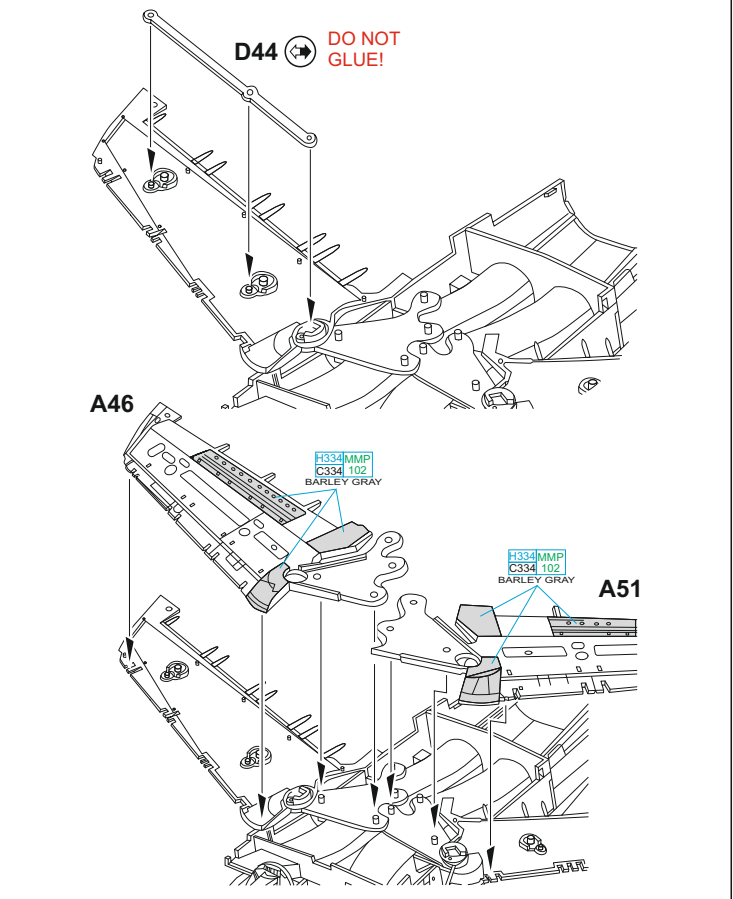
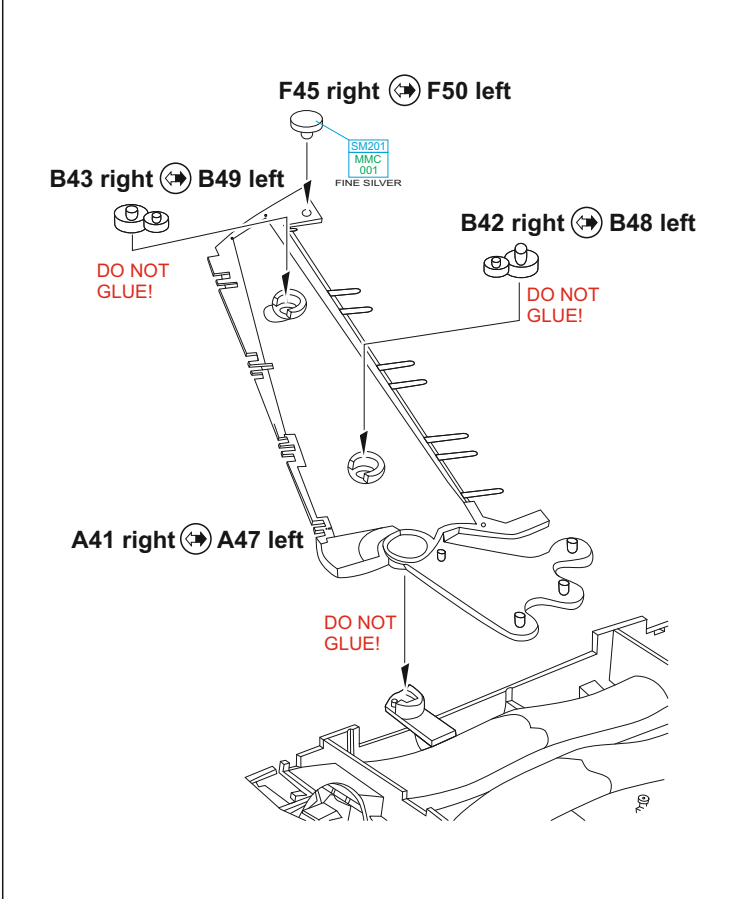
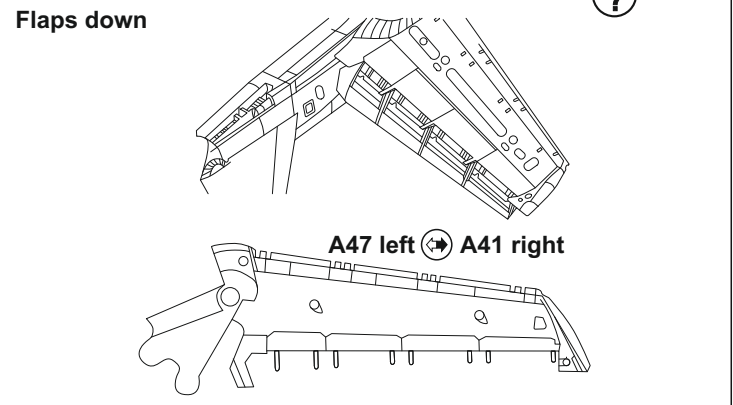
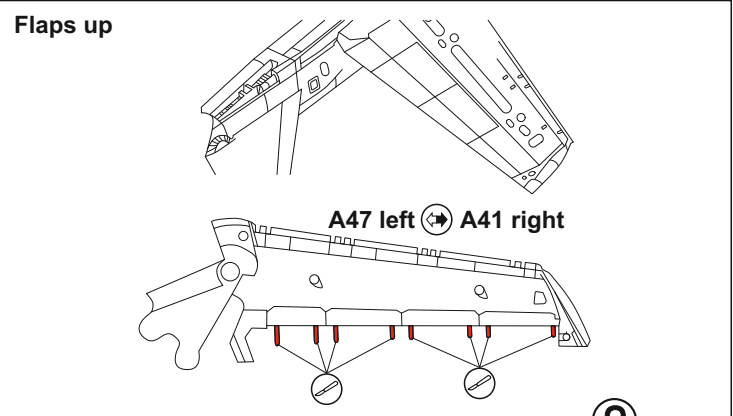
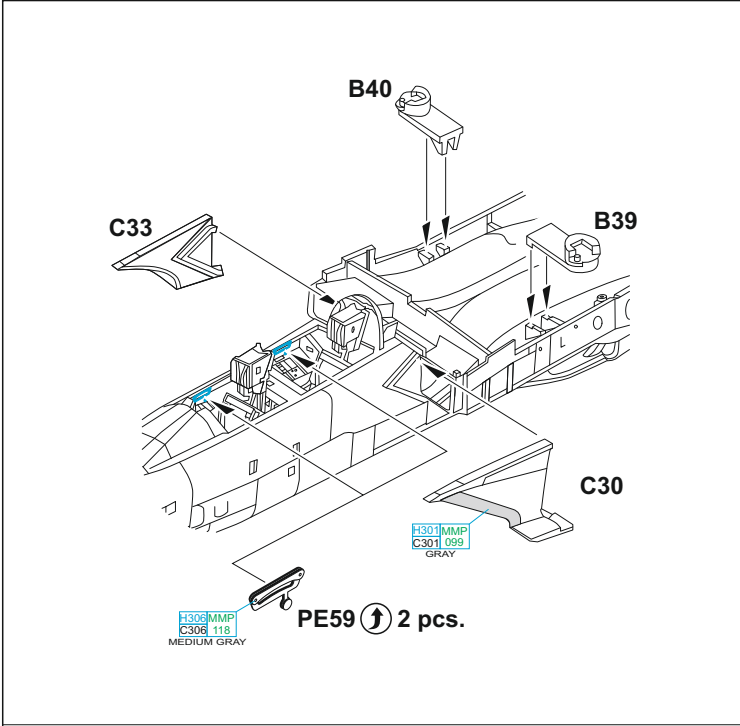

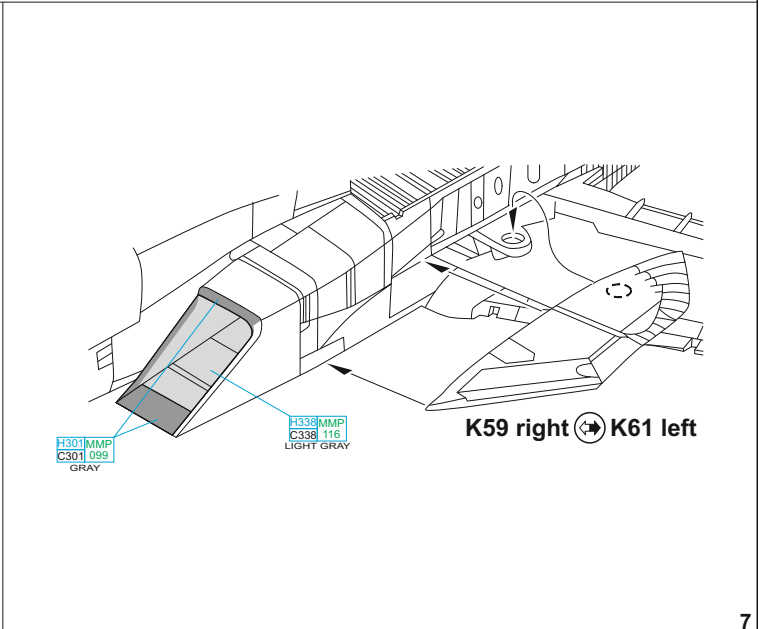
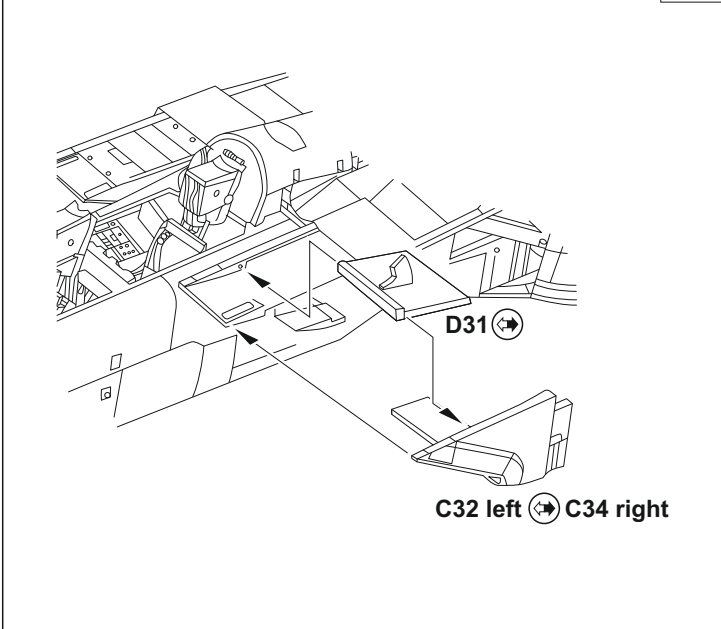
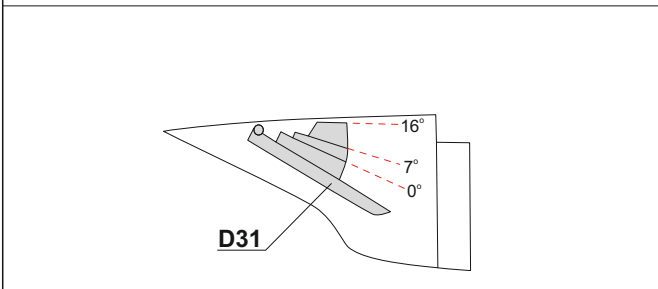
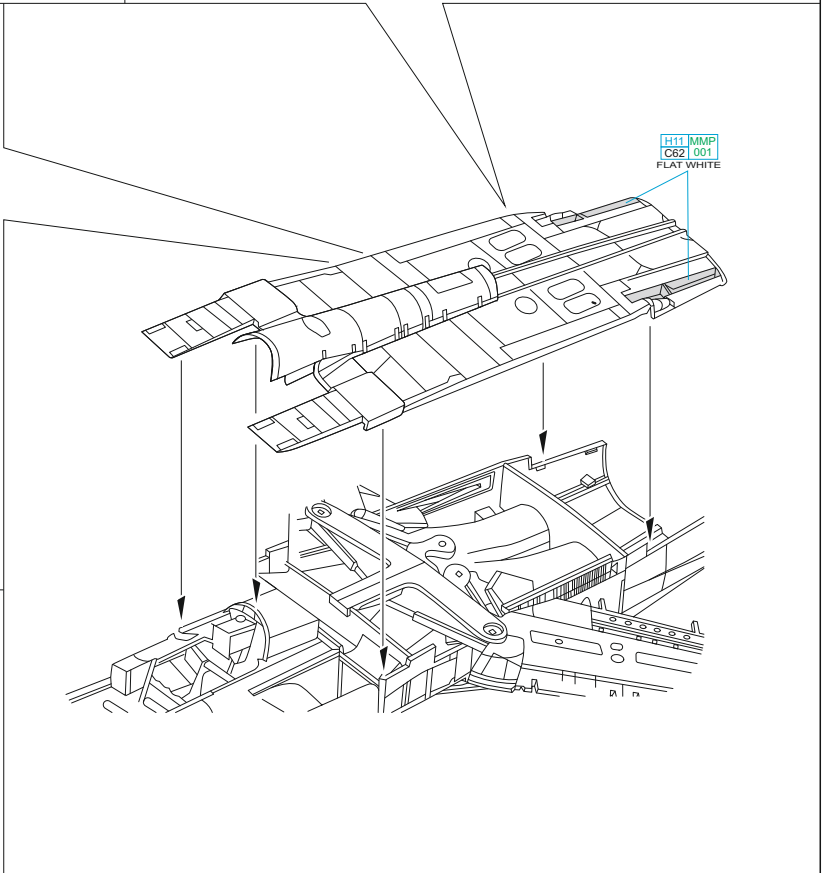
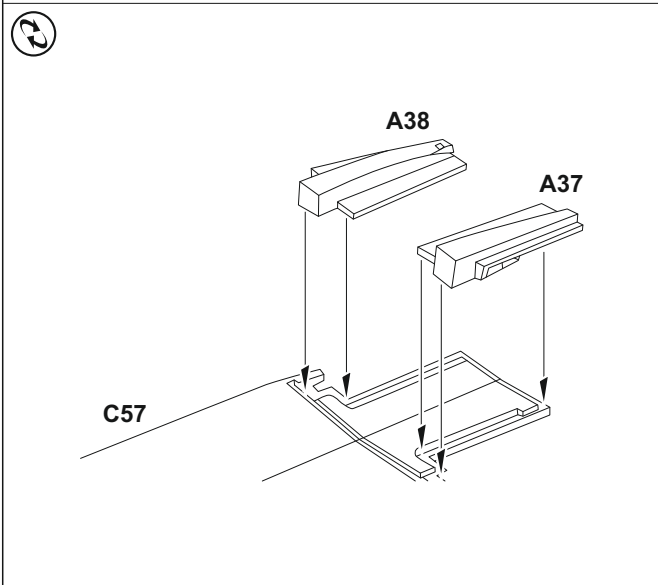
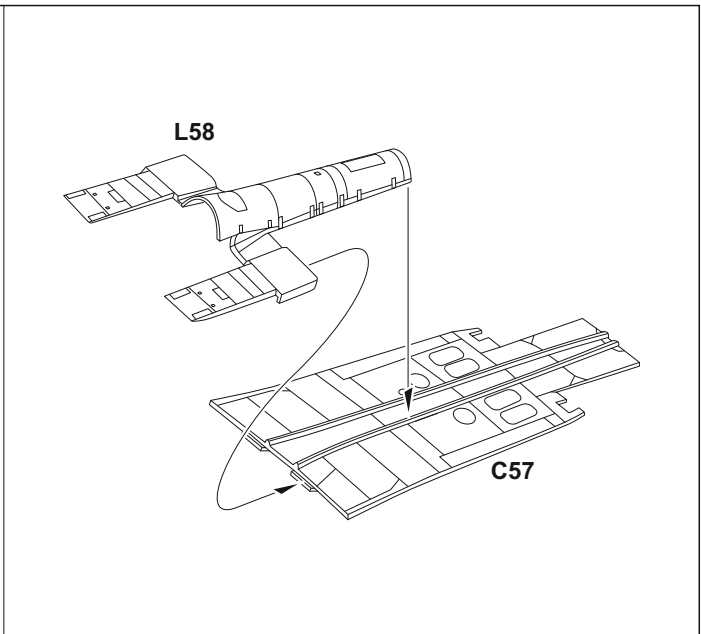
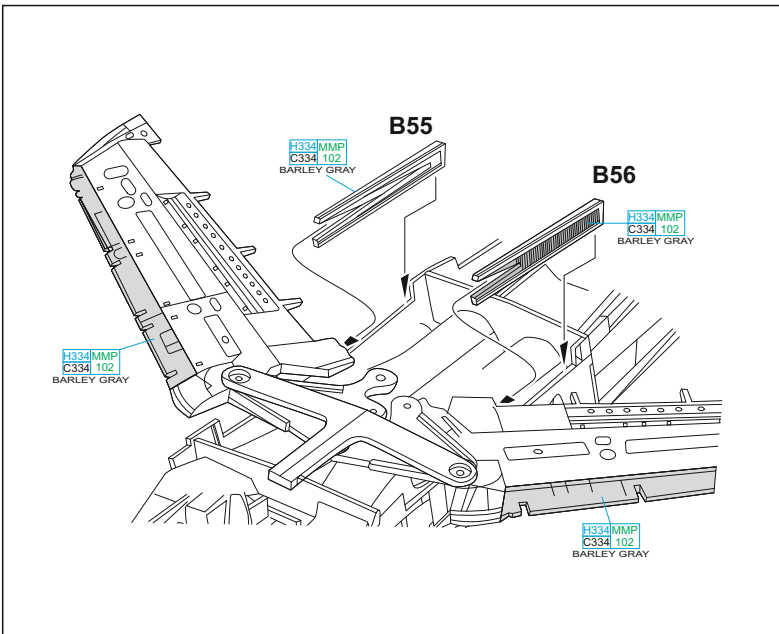

K62 left ↔ K60 right

DO NOT GLUE!

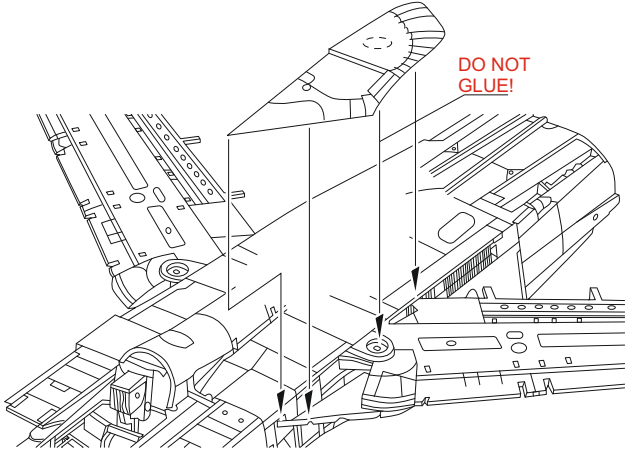

T65

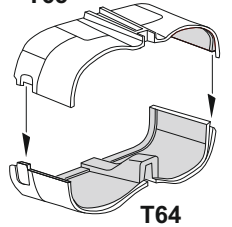

T64

DO NOT GLUE!

E63

DO NOT GLUE!

E63

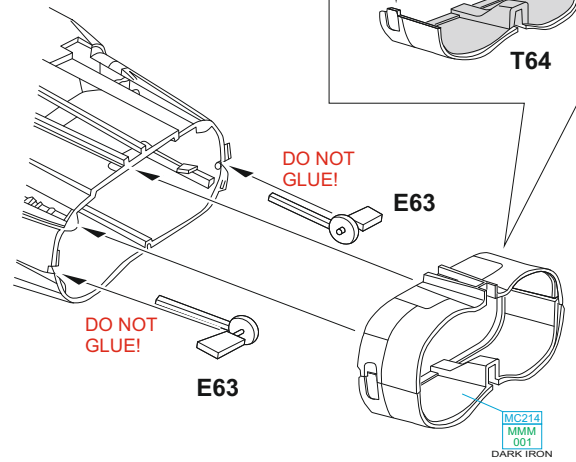

MC214
MMM
001
DARK IRON

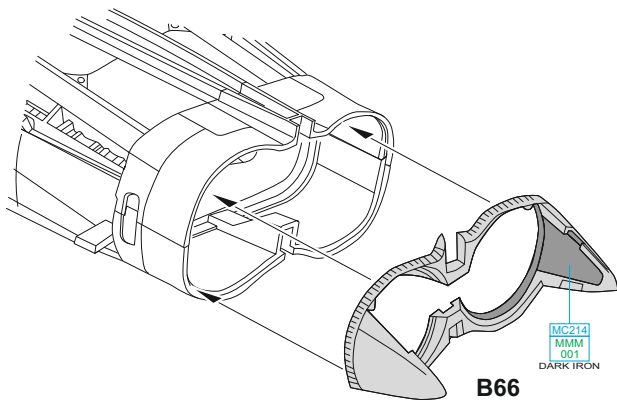

B66

MC214
MMM
001
DARK IRON

T70

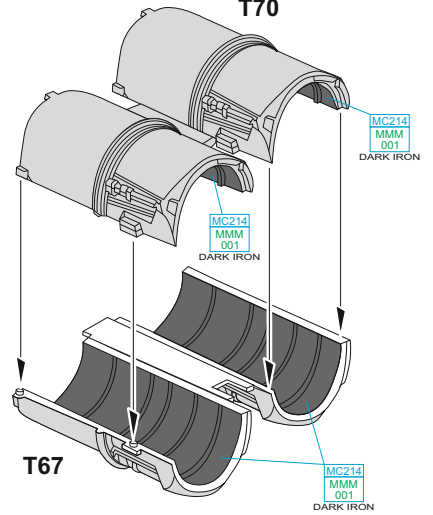

T67

MC214
MMM
001
DARK IRON

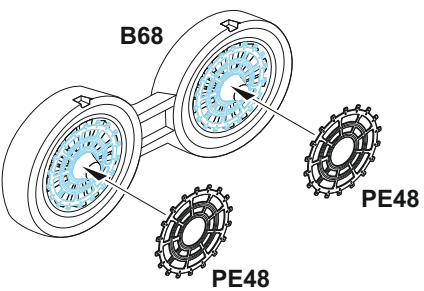

B68

PE48

PE48

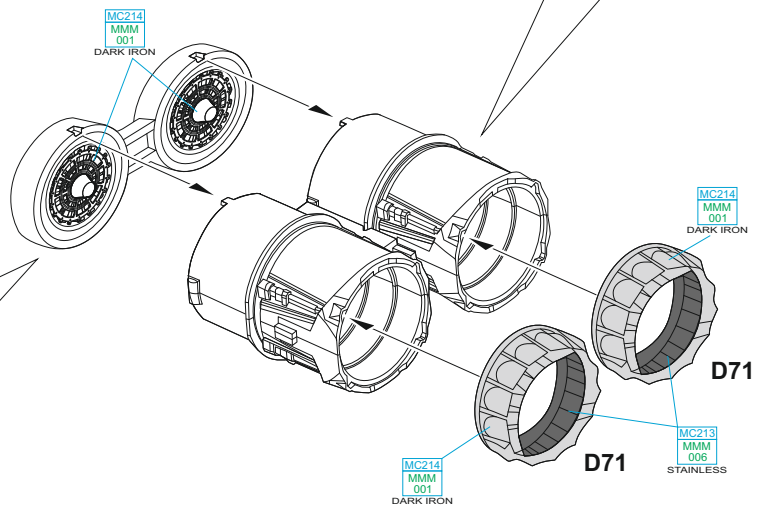

MC214
MMM
001
DARK IRON

D71

D71

MC214
MMM
001
DARK IRON

MC213
MMM
005
STAINLESS

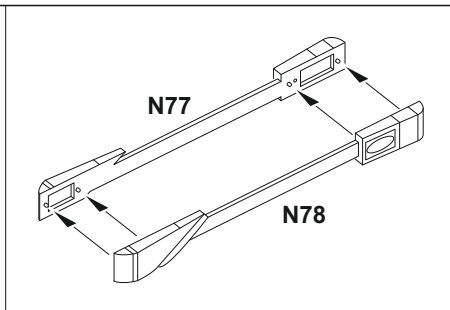
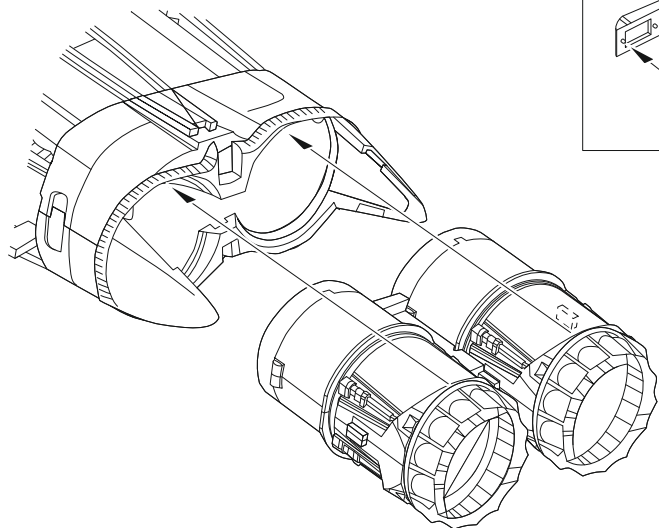

N77

N78

E

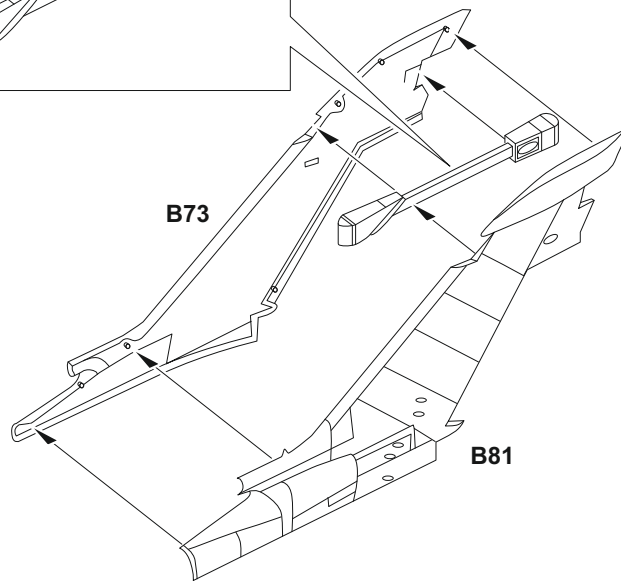

B73

B81

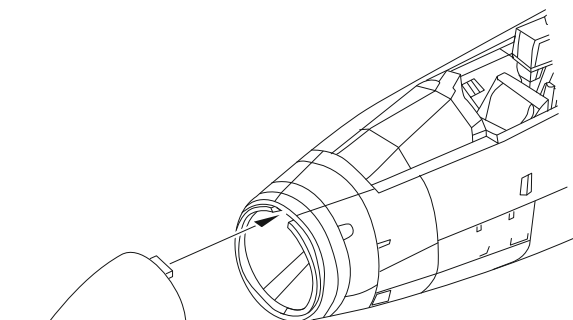

J72



Don't forget
to add the nose
weight balance!

F

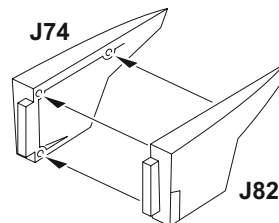

J74

J82

G

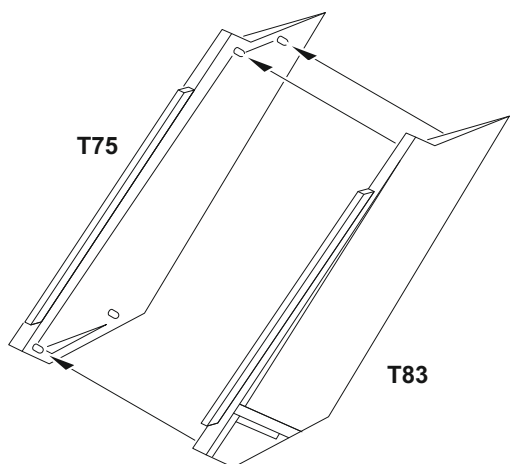

T75

T83

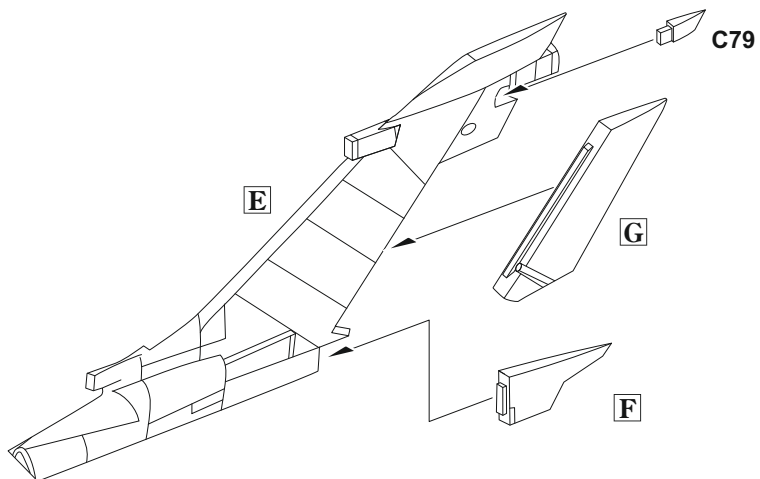

E

G

F

C79

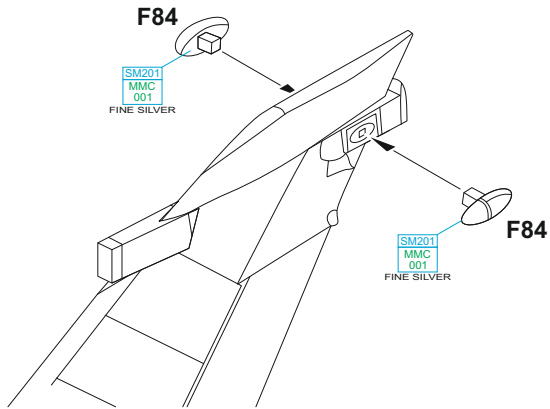

H 2 pcs.

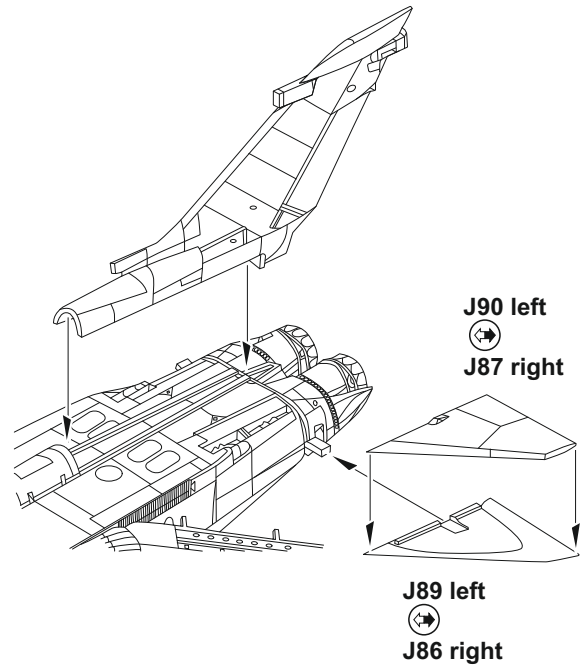
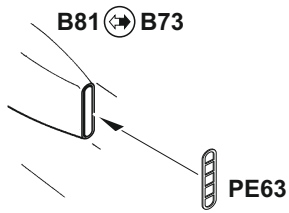

Slats up

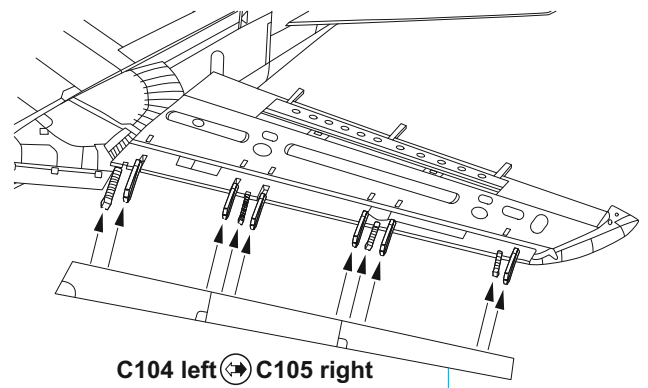
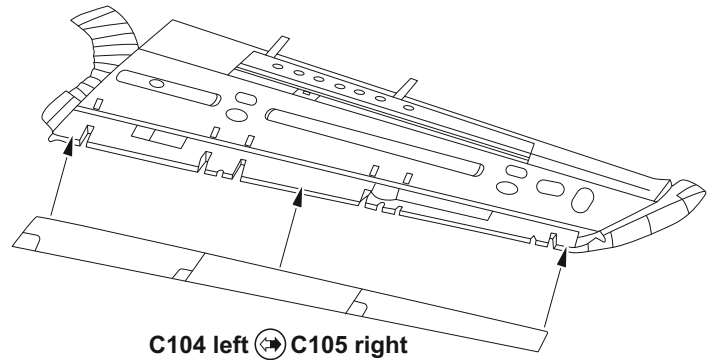

FOR ANNIVERSARY TORNADO
USE COLOR AS ON MARKING **D**

Slats down

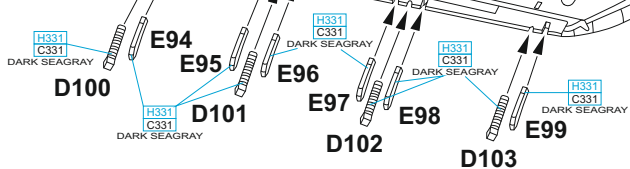

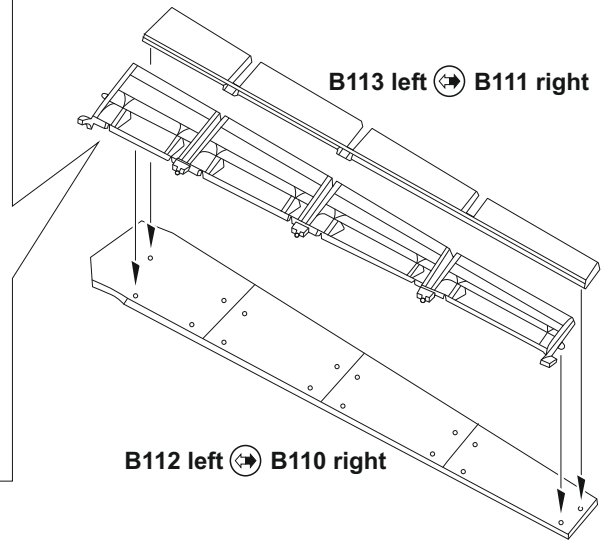
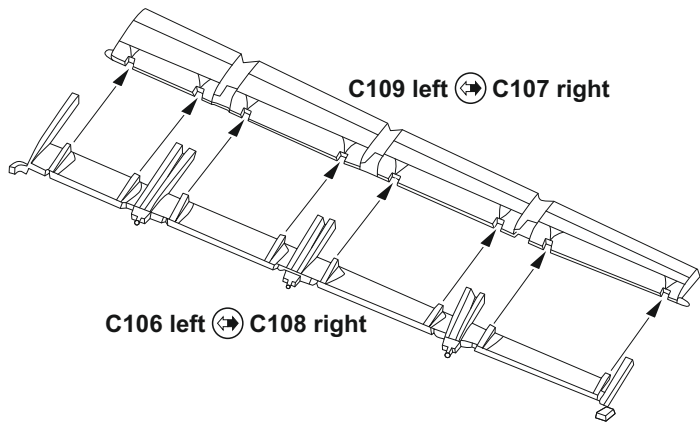

Flaps down

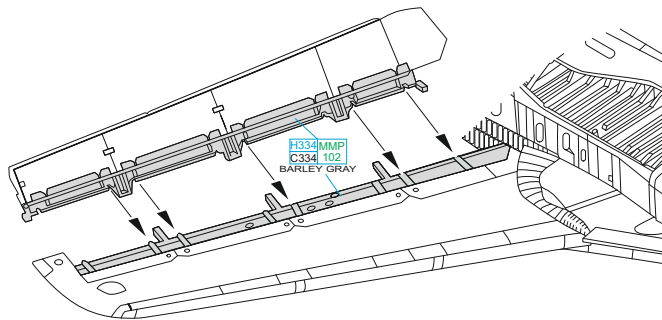

Flaps up

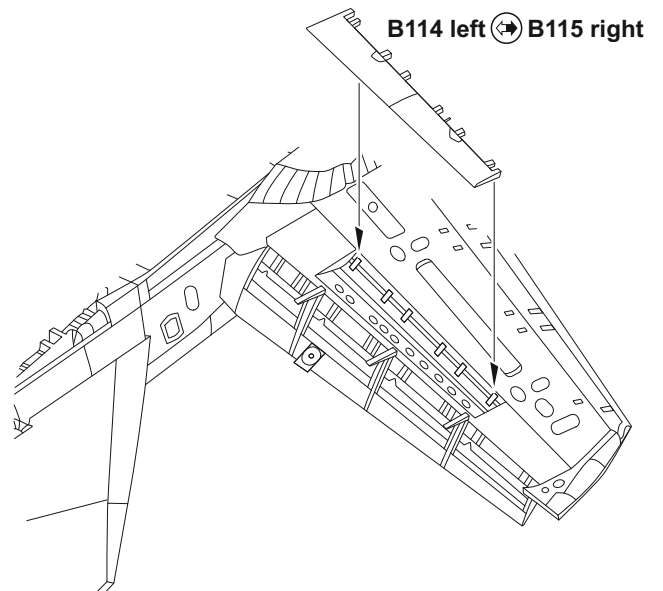
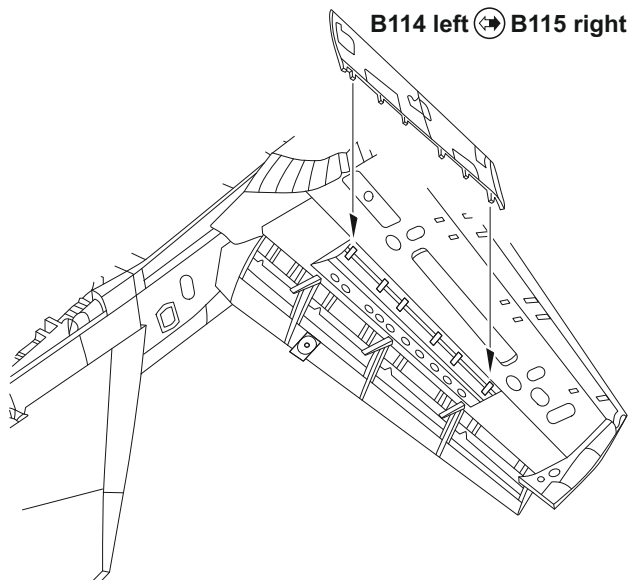
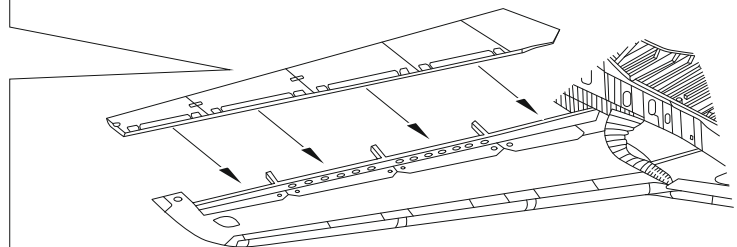
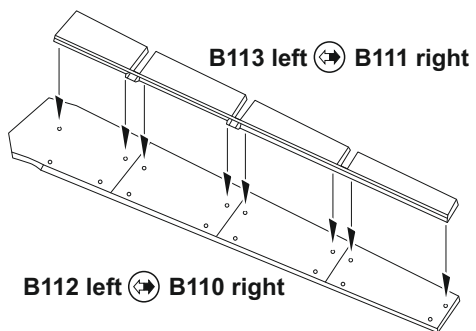

J

A37 right

A38 left

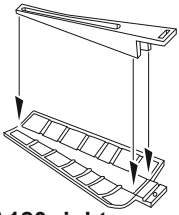

A120 right

A118 left



D117

J

H338 MMP
C338 116
LIGHT GRAY

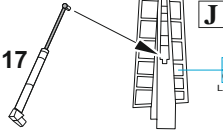

SM201
MMC
001
FINE SILVER

D117

J

H111 MMP
C621 001
FLAT WHITE

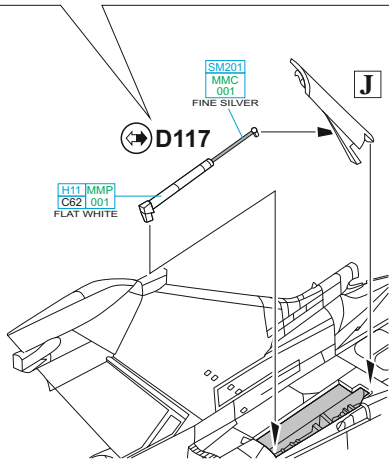

A120 right ↔ **A118 left**

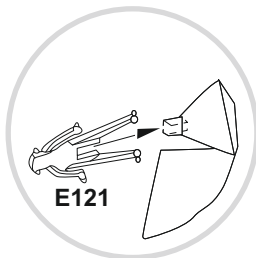
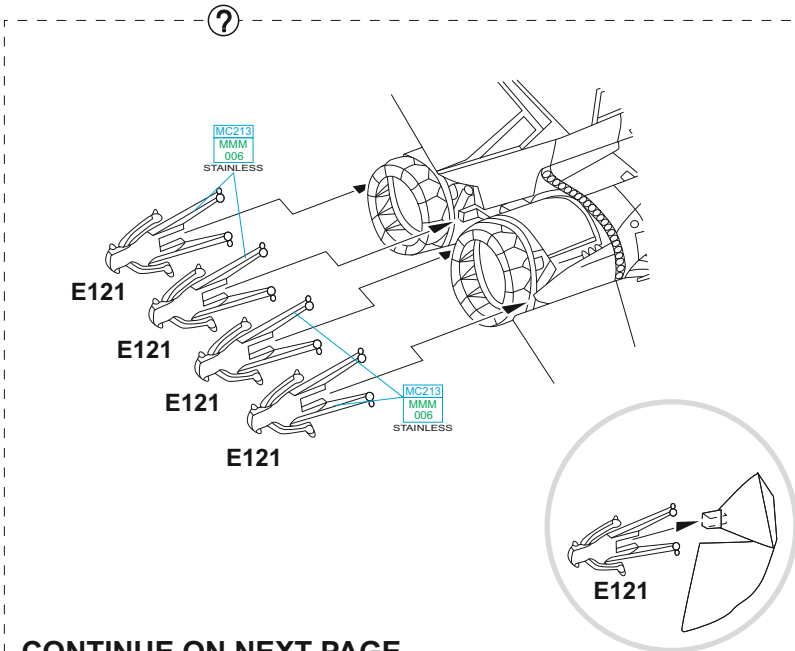
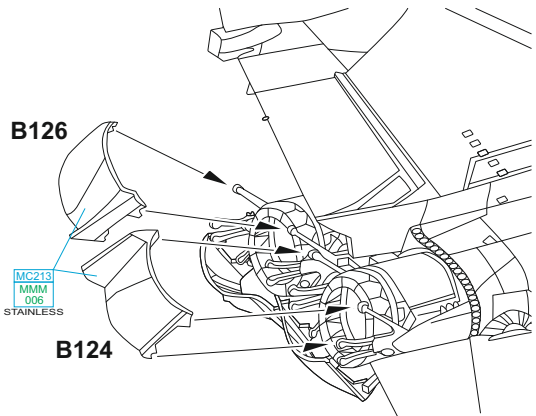
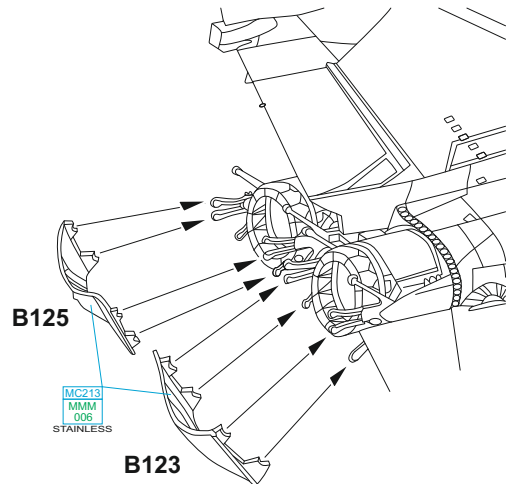
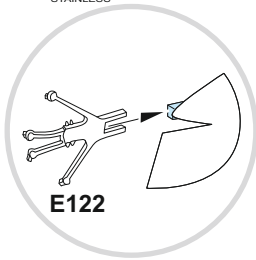
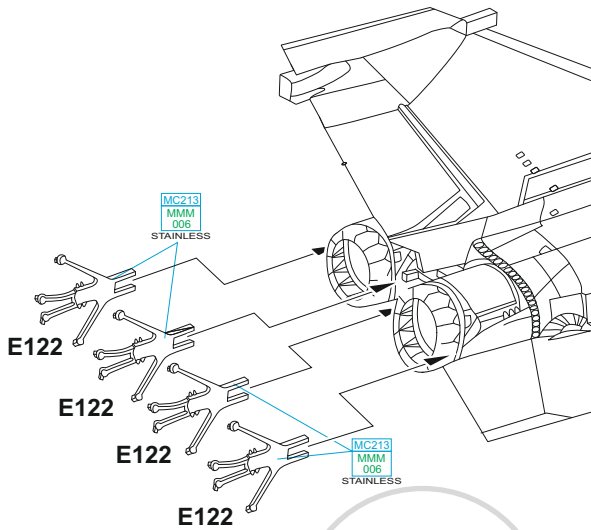
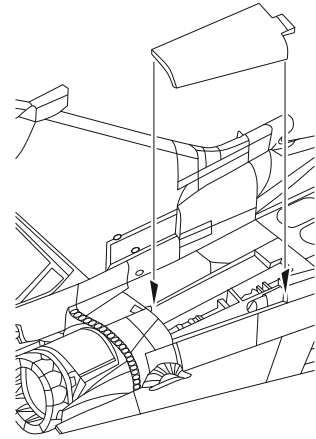

K

B124 right ↔ B126 left

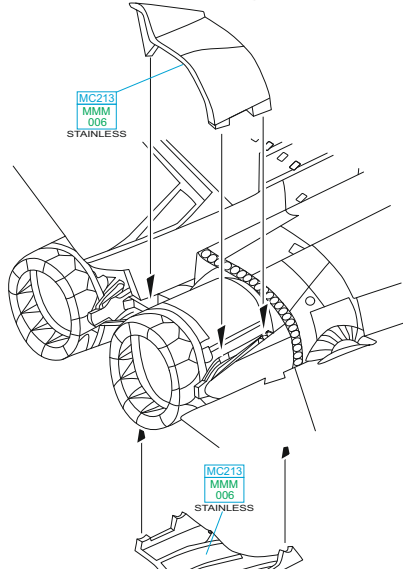

B123 right ↔ B125 left

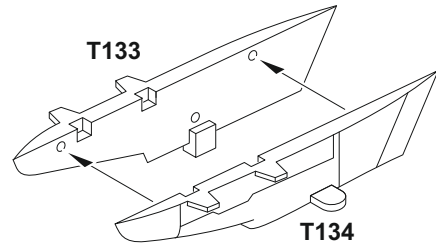
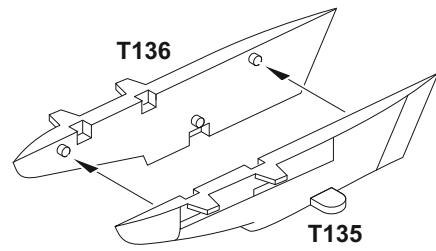
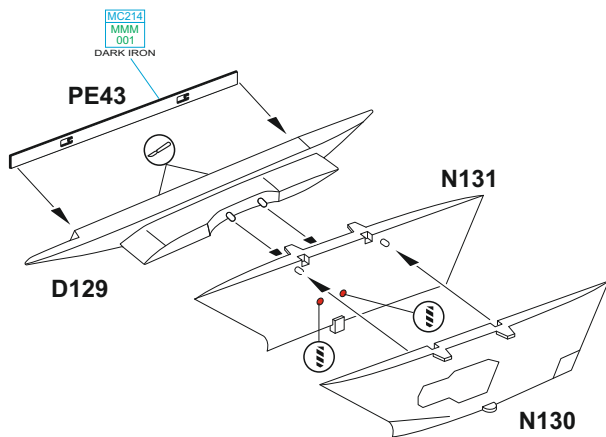
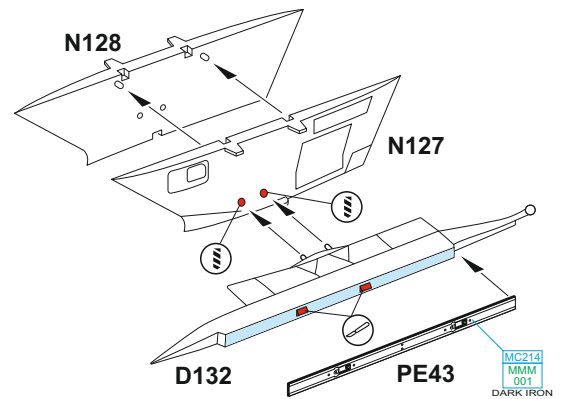
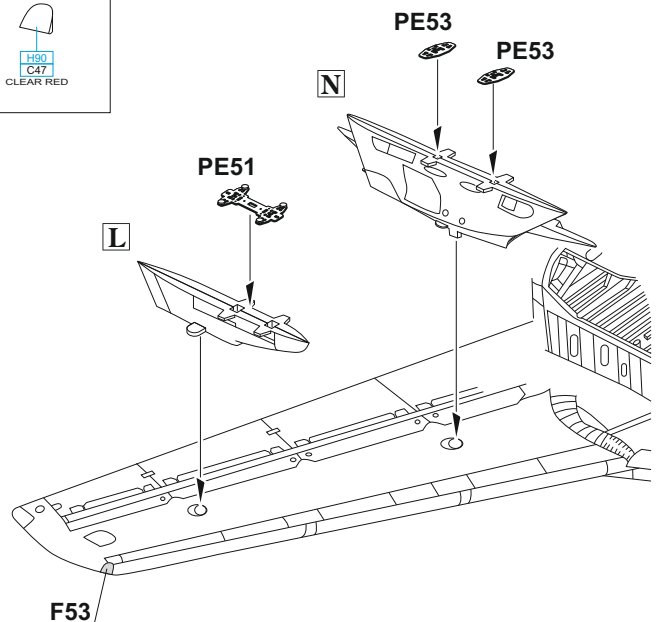
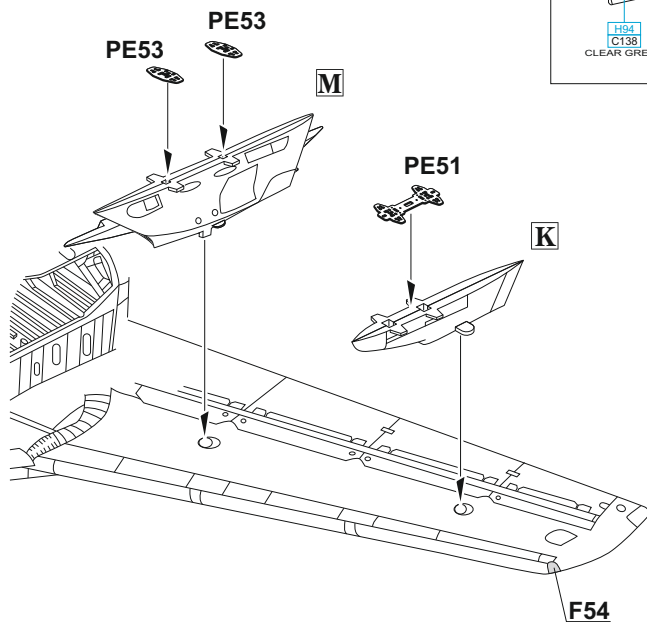
L**M****N****F54****F53**

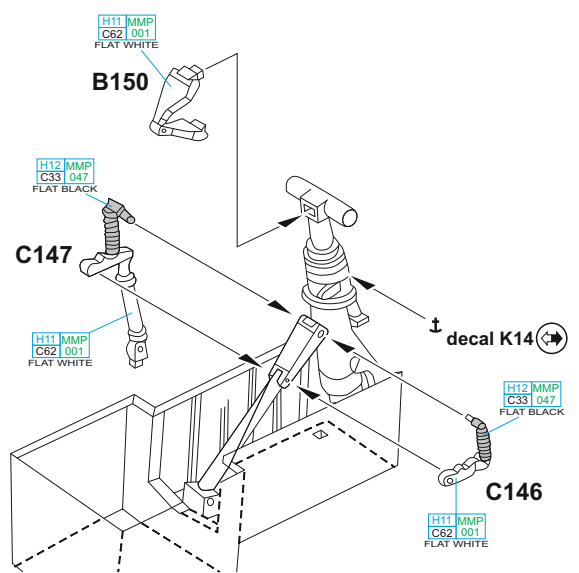
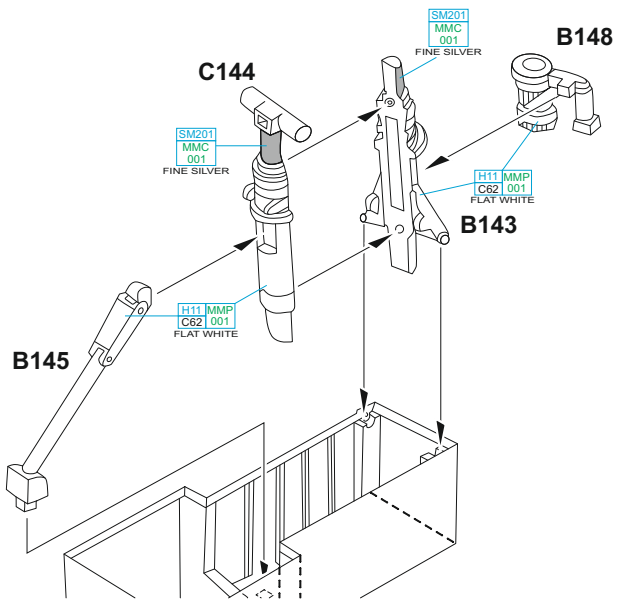

eduard
BRASSIN

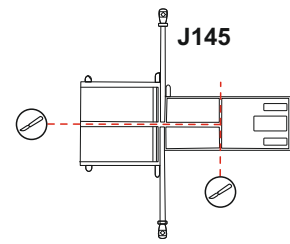
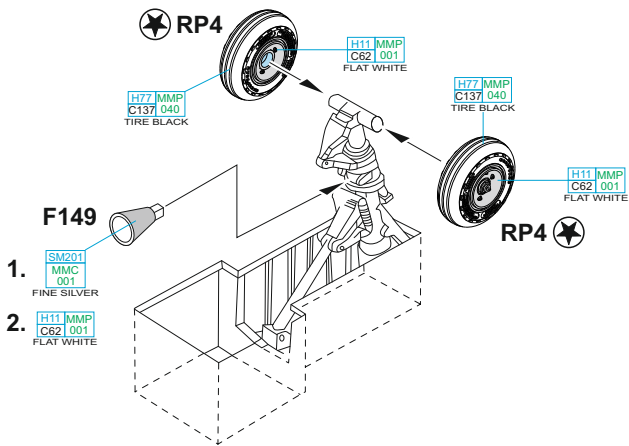

M **N**

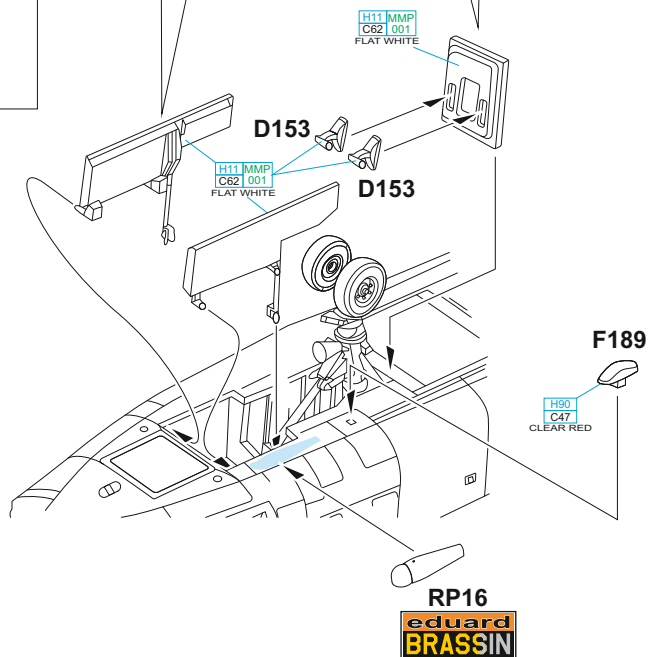
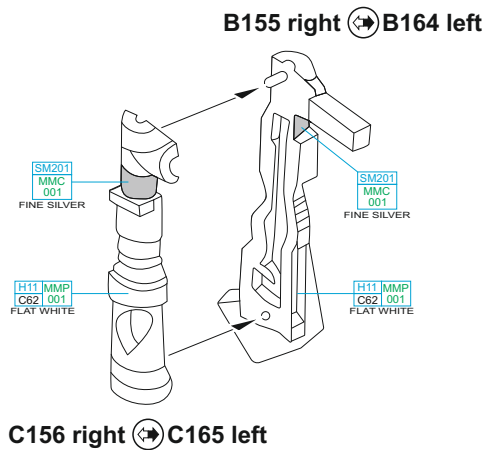

eduard
BRASSIN

M → N

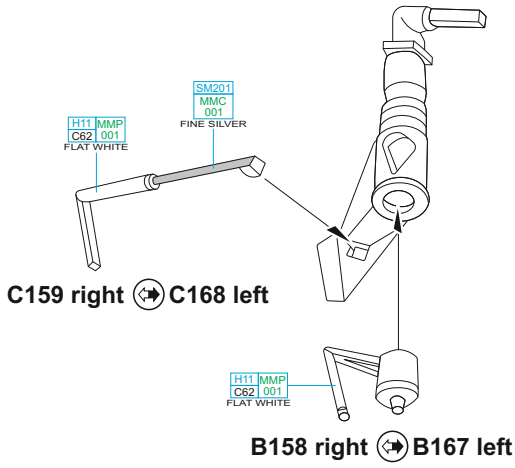

M → N

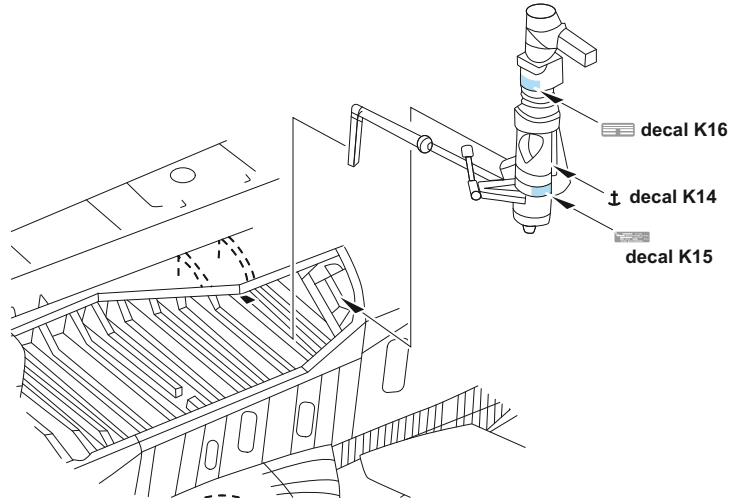

M → N

B157 right ↔ B166 left

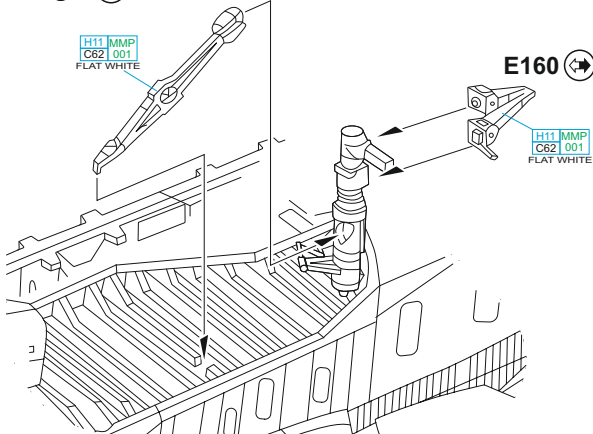

M → N

eduard BRASSIN

RP1 ↔

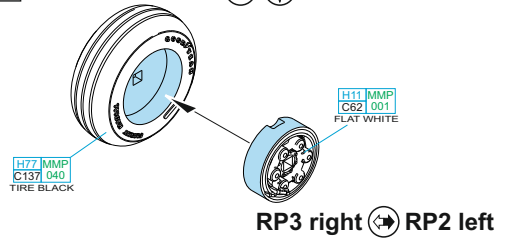

M → N

M → N

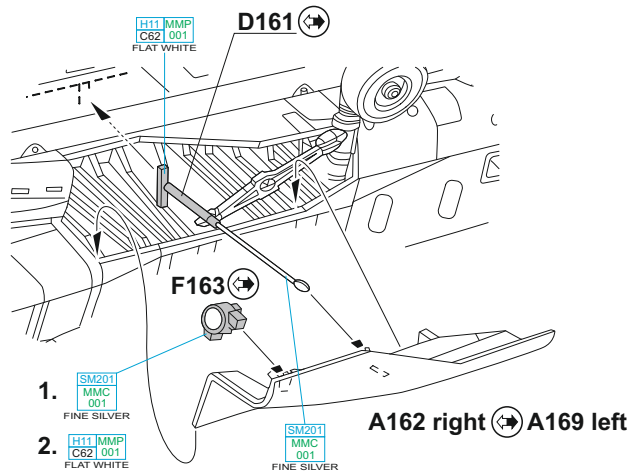

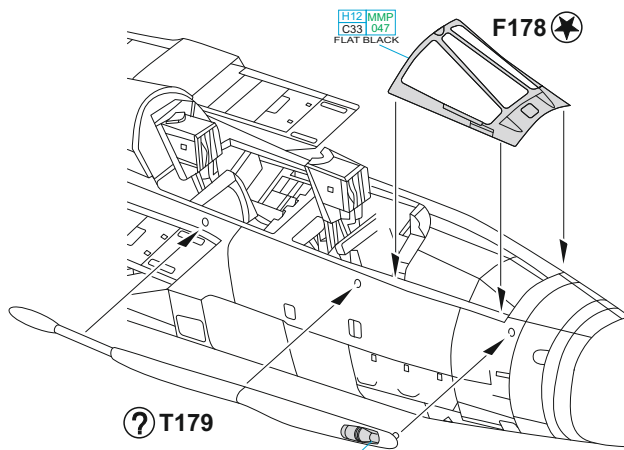

T179 - MARKINGS **B, C, D, E** ONLY

SM201
MMC
001
FINE SILVER

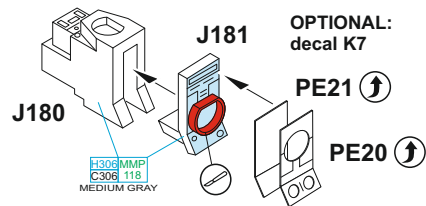

2 pcs.

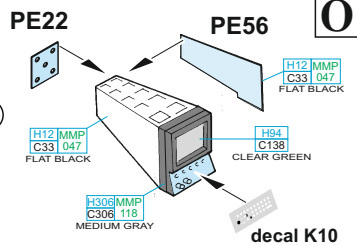
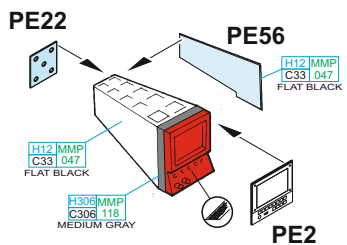
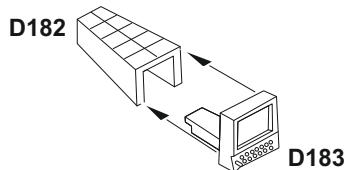

O

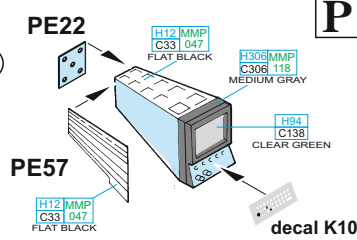
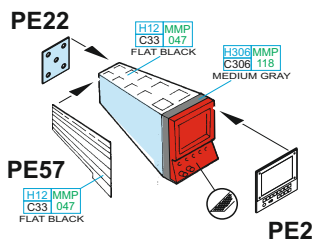

P

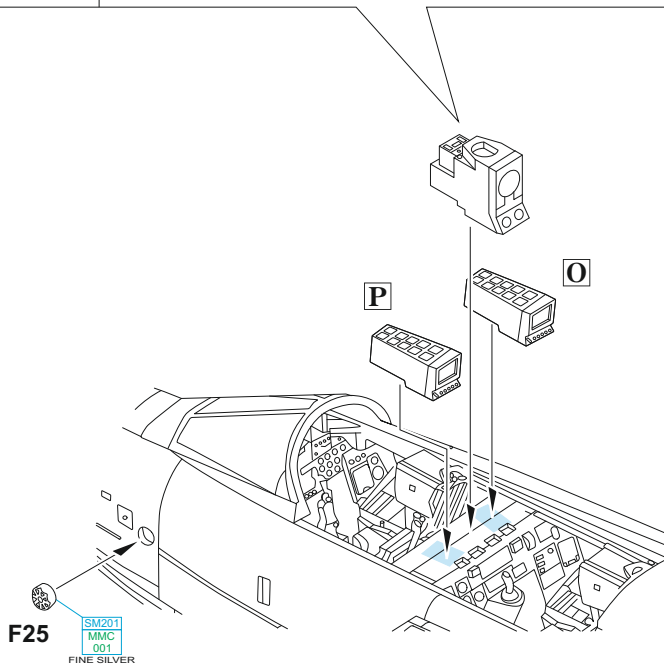

F25
SM201
MMC
001
FINE SILVER

OPEN CANOPY

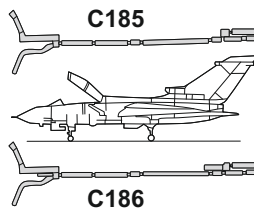

CLOSED CANOPY

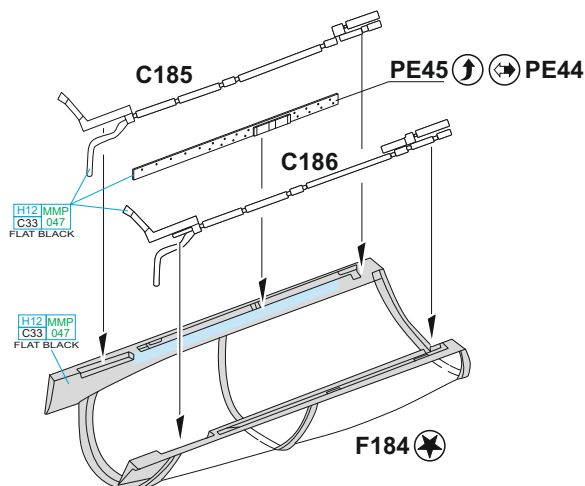
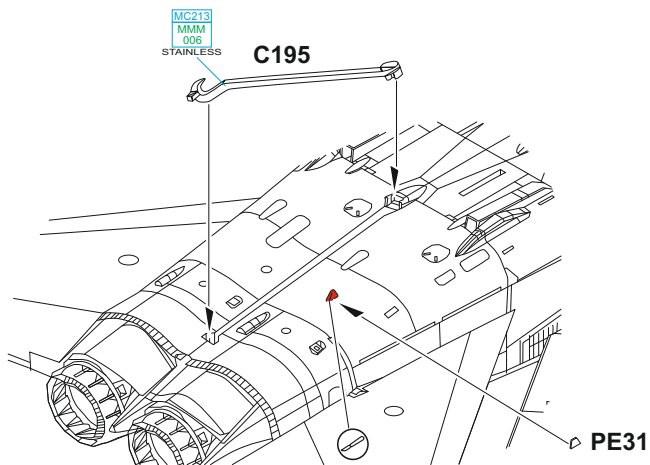
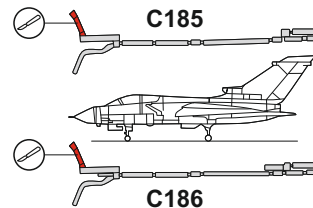

F184

PE52

H12	MMP
C33	C47
FLAT BLACK	
SM201	
MMC	001
FINE SILVER	

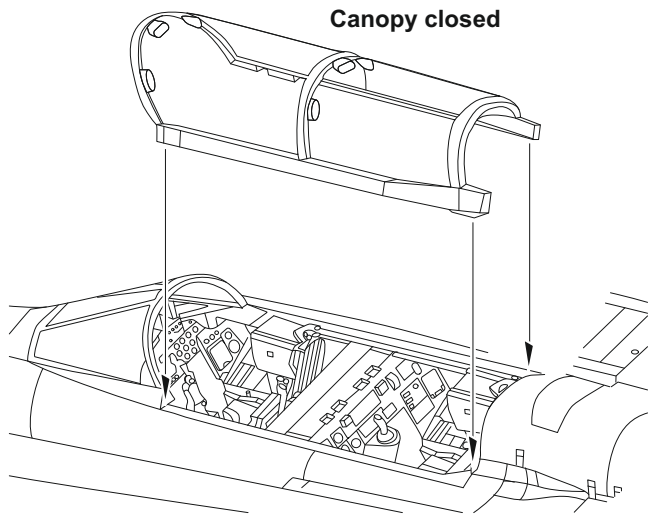
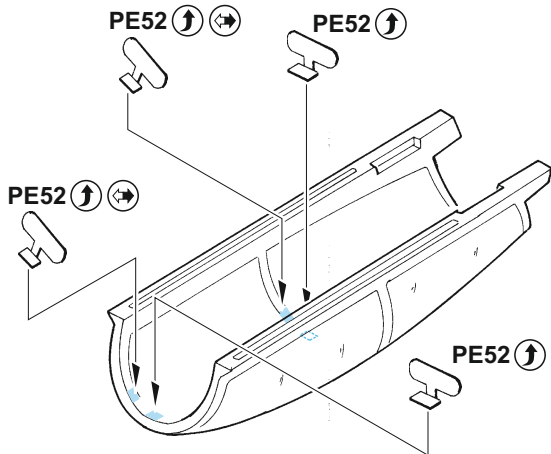

?

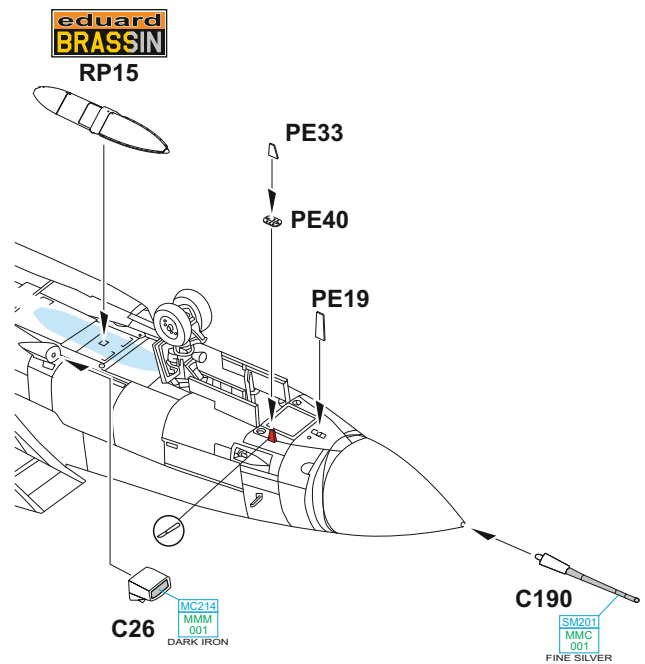
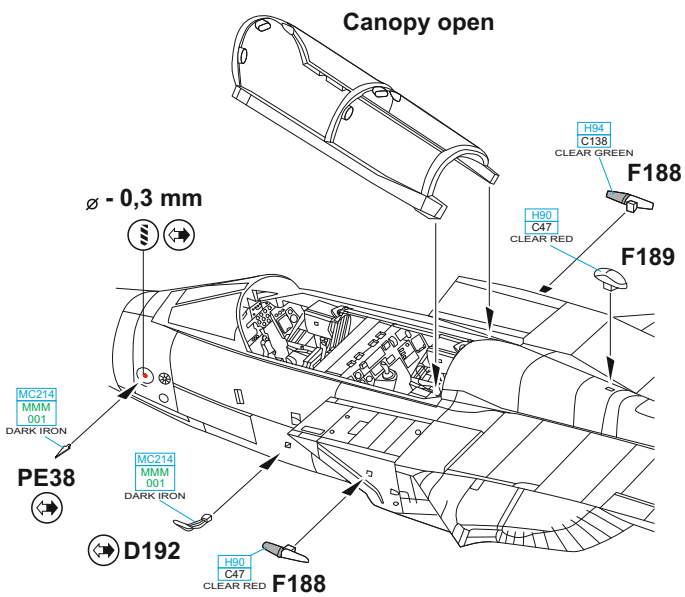

Q ? MARKING ONLY

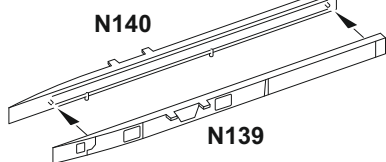

R

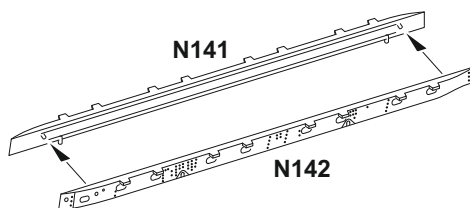

S

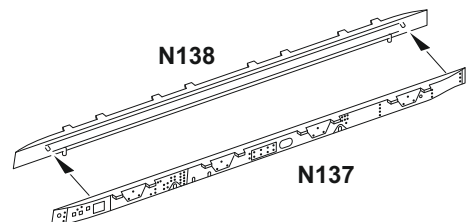

? MARKING **E** ONLY

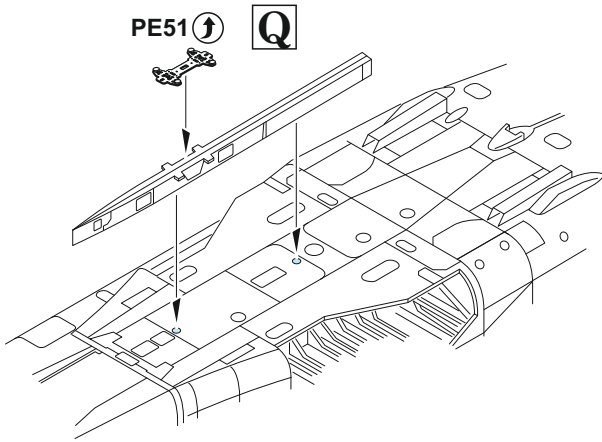

?

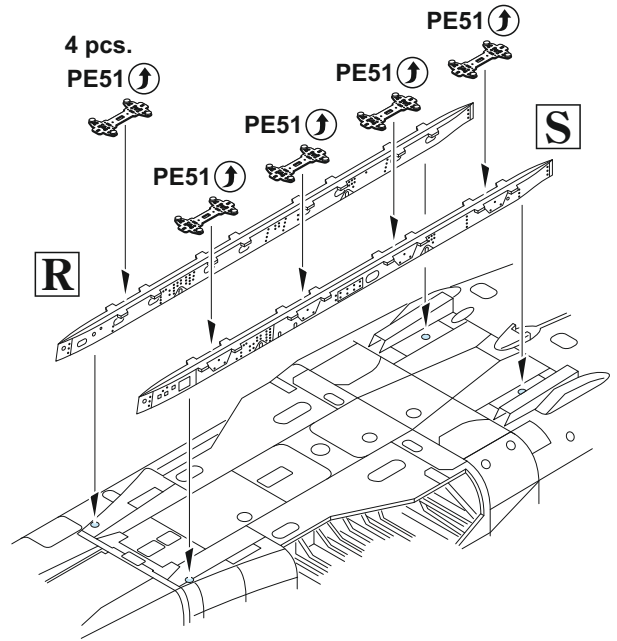

T **?** 2 pcs.

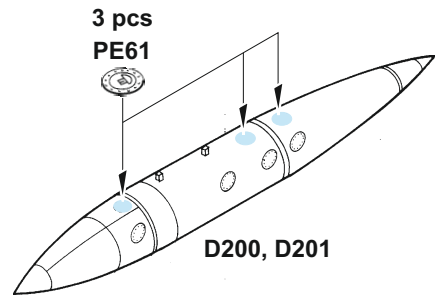
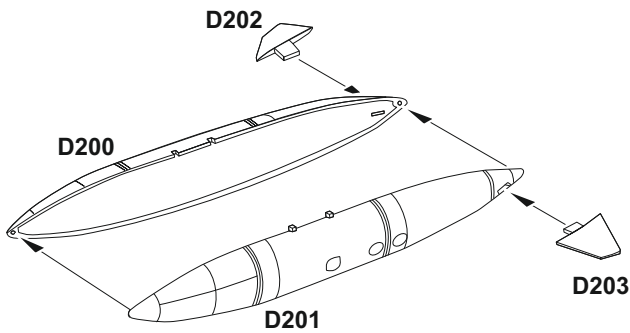

U **?** 2 pcs.

2 pcs. - MARKING **E** ONLY

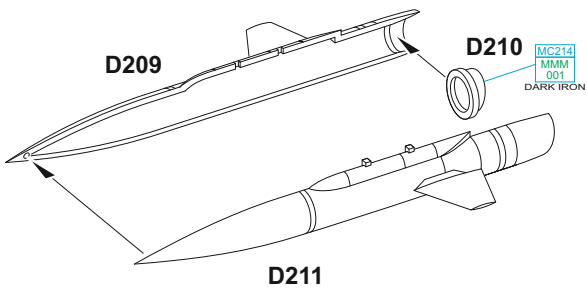

V

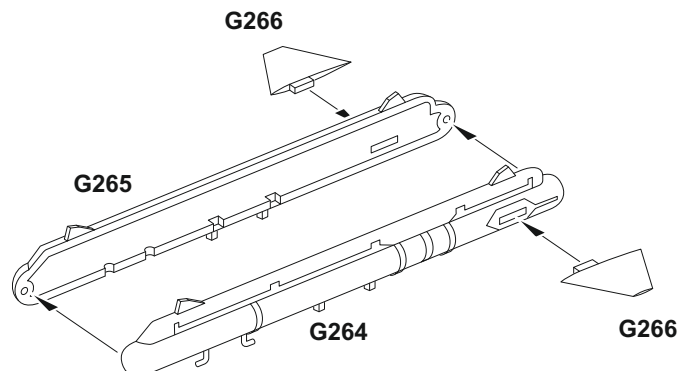

M → N

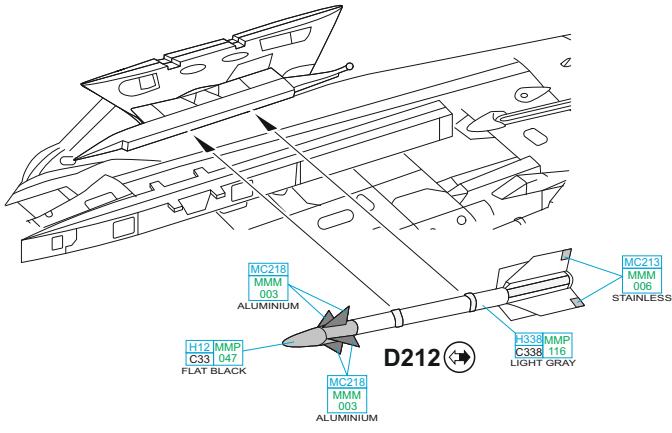

U

T

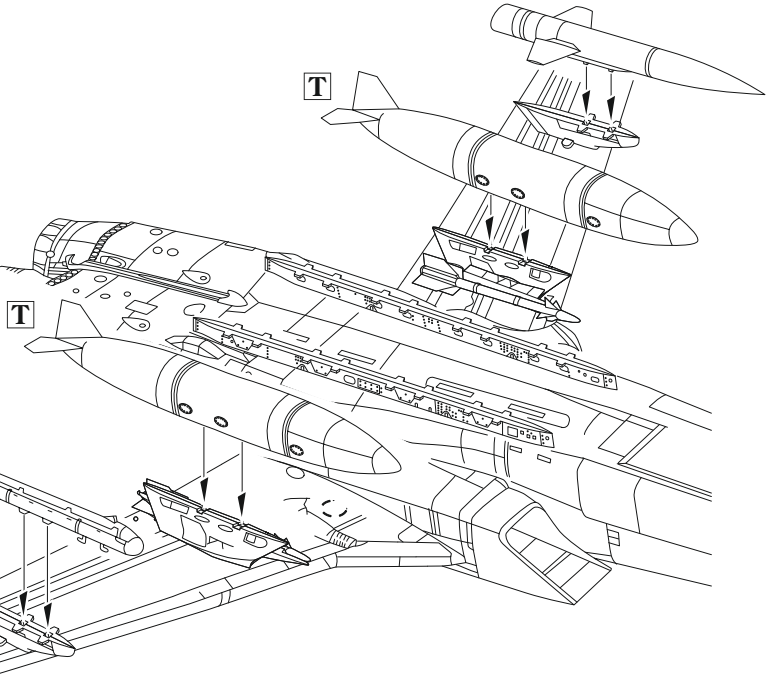

U - MARKING E ONLY

U ? V

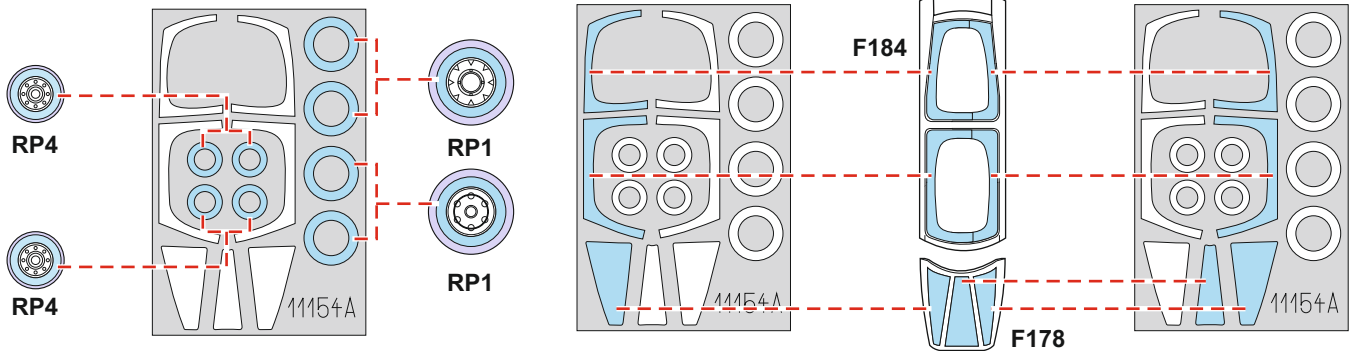
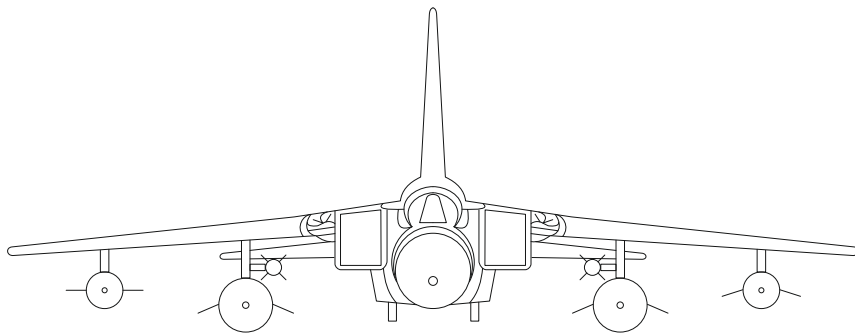

LEFT OUTER PYLON

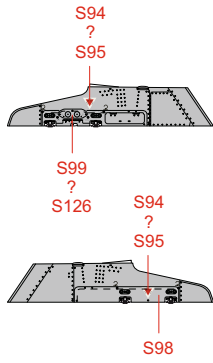

RIGHT OUTER PYLON

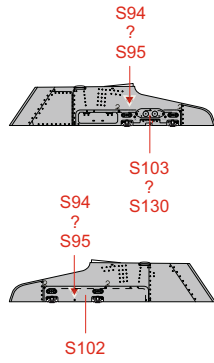

LEFT INNER PYLON

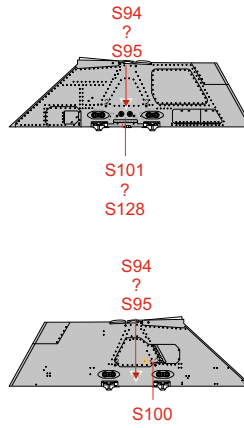

RIGHT INNER PYLON

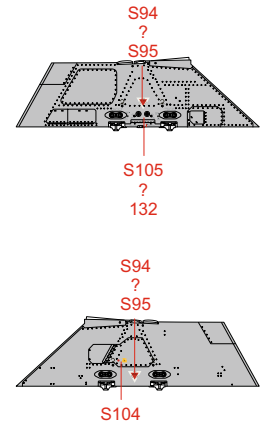

RIGHT FUSELAGE PYLON

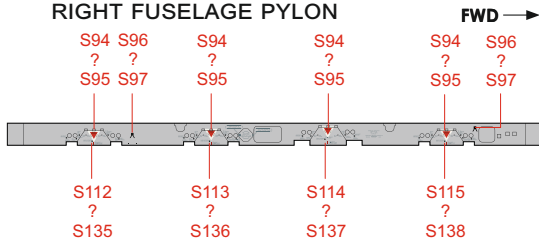

CENTER PYLON - LEFT

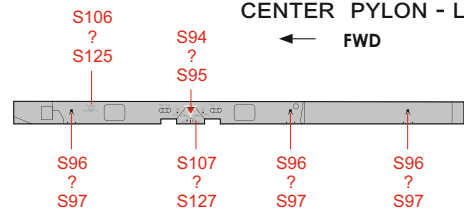

LEFT FUSELAGE PYLON

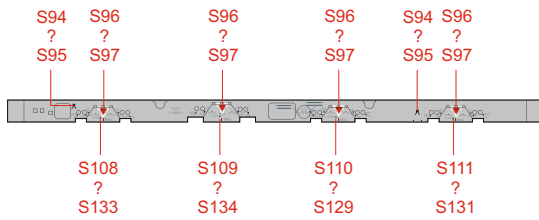

CENTER PYLON - RIGHT

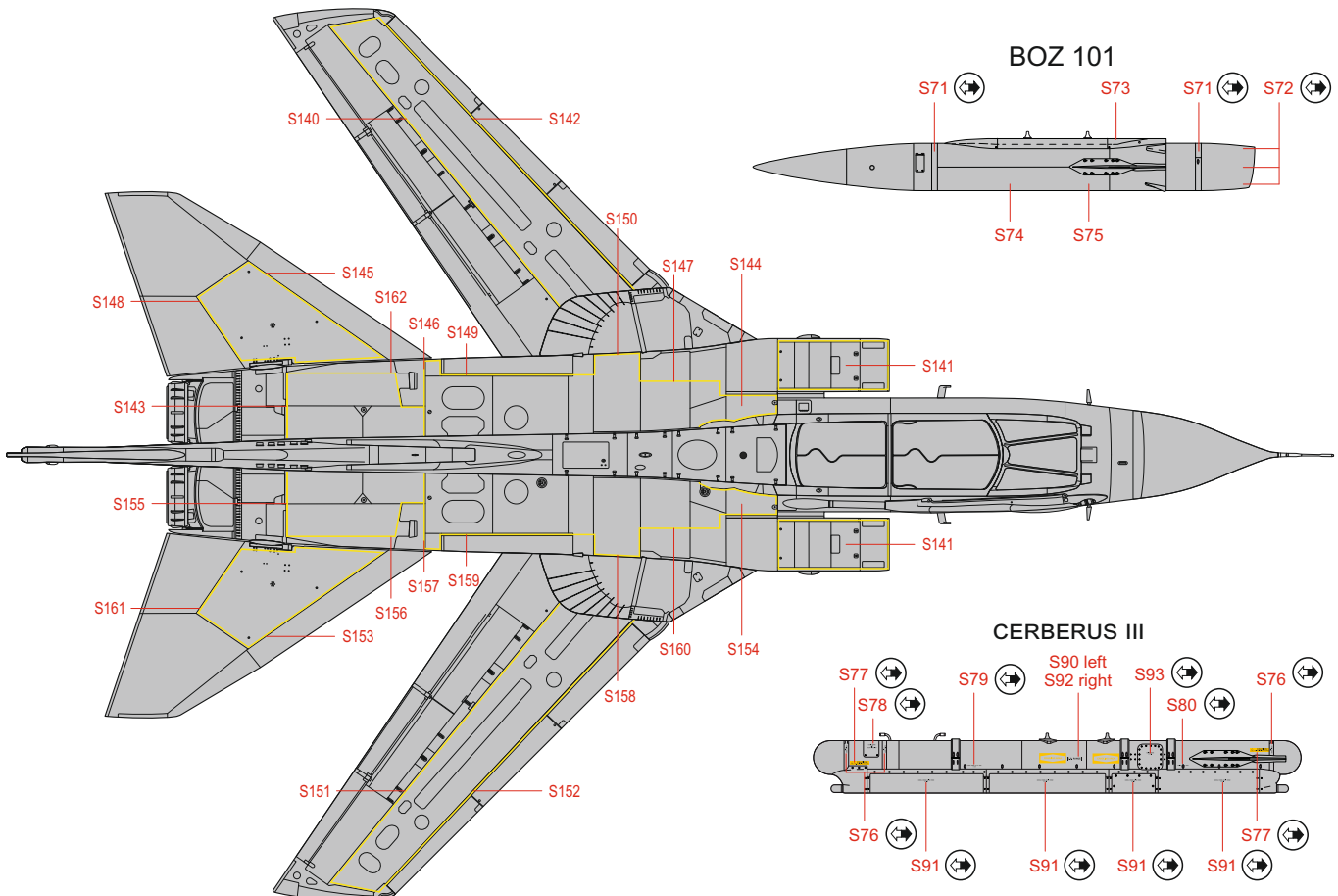
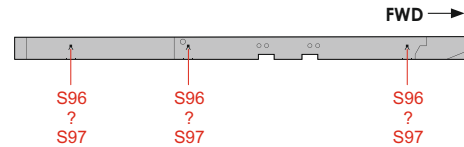

Auxiliary tank 1500l

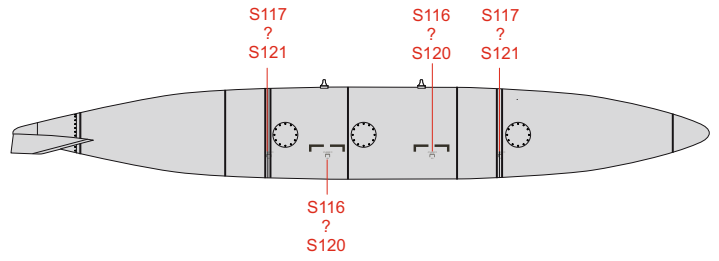
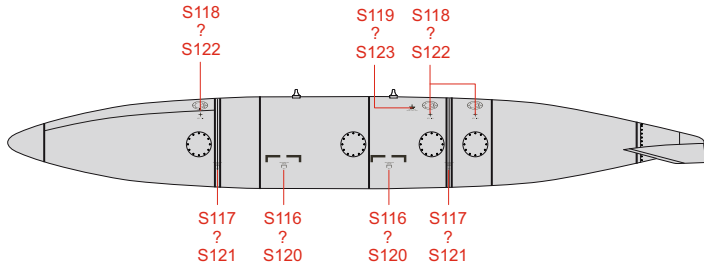

Sidewinder 2x

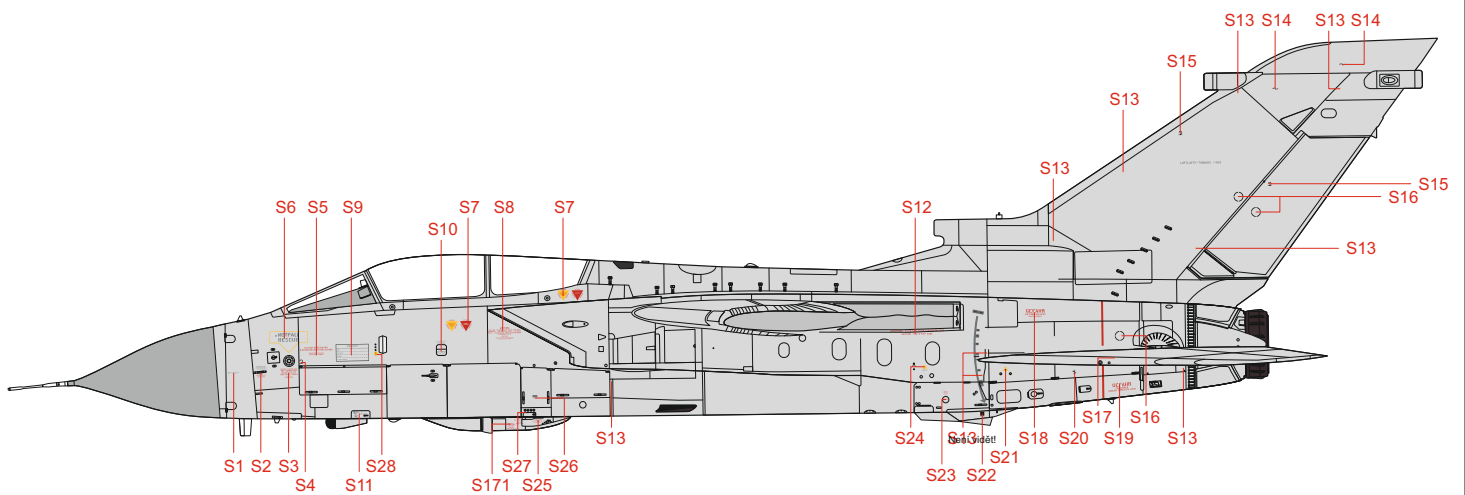
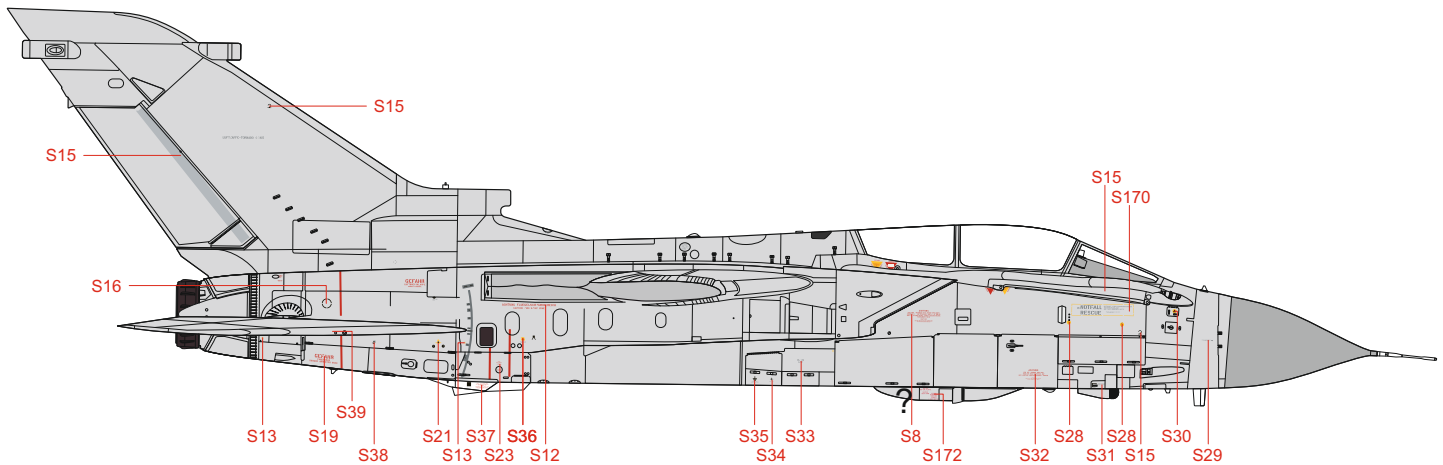
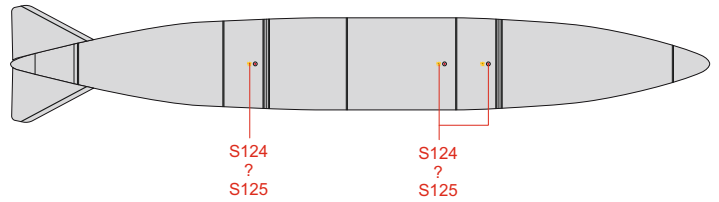
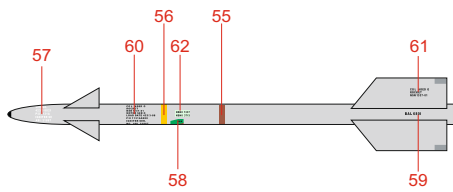

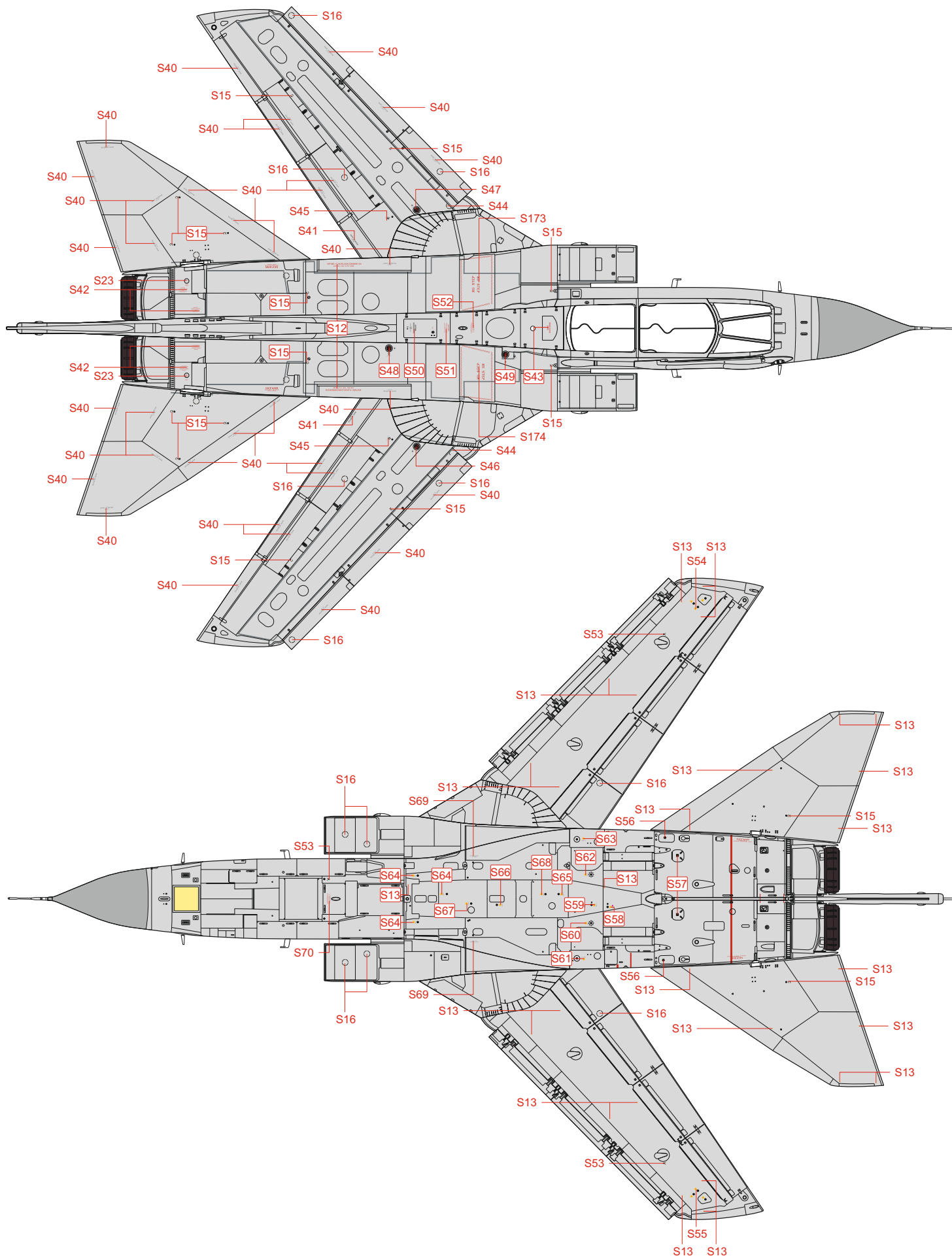

A 46+23, JaboG 32, letecká základna Lechfeld, Německo, červenec 2008

Jagdbombergeschwader 32 byla založena na základně v Lechfeldu v červenci 1958. Zpočátku byla vyzbrojena stíhačkami F-84F Thunderstreak, během roku 1965 následovalo přezbrojení na Starfighters, které v roce 1984 nahradily Tornada verze IDS. Tyto stíhací bombardéry byly v roce 1991 doplněny Tornady ECR, určenými pro elektronický boj. K padesátému výročí založení jednotky bylo Tornado ECR s označením 46+23 přestříkáno dle návrhu designérky Daniely „Delahé“ Krahe.

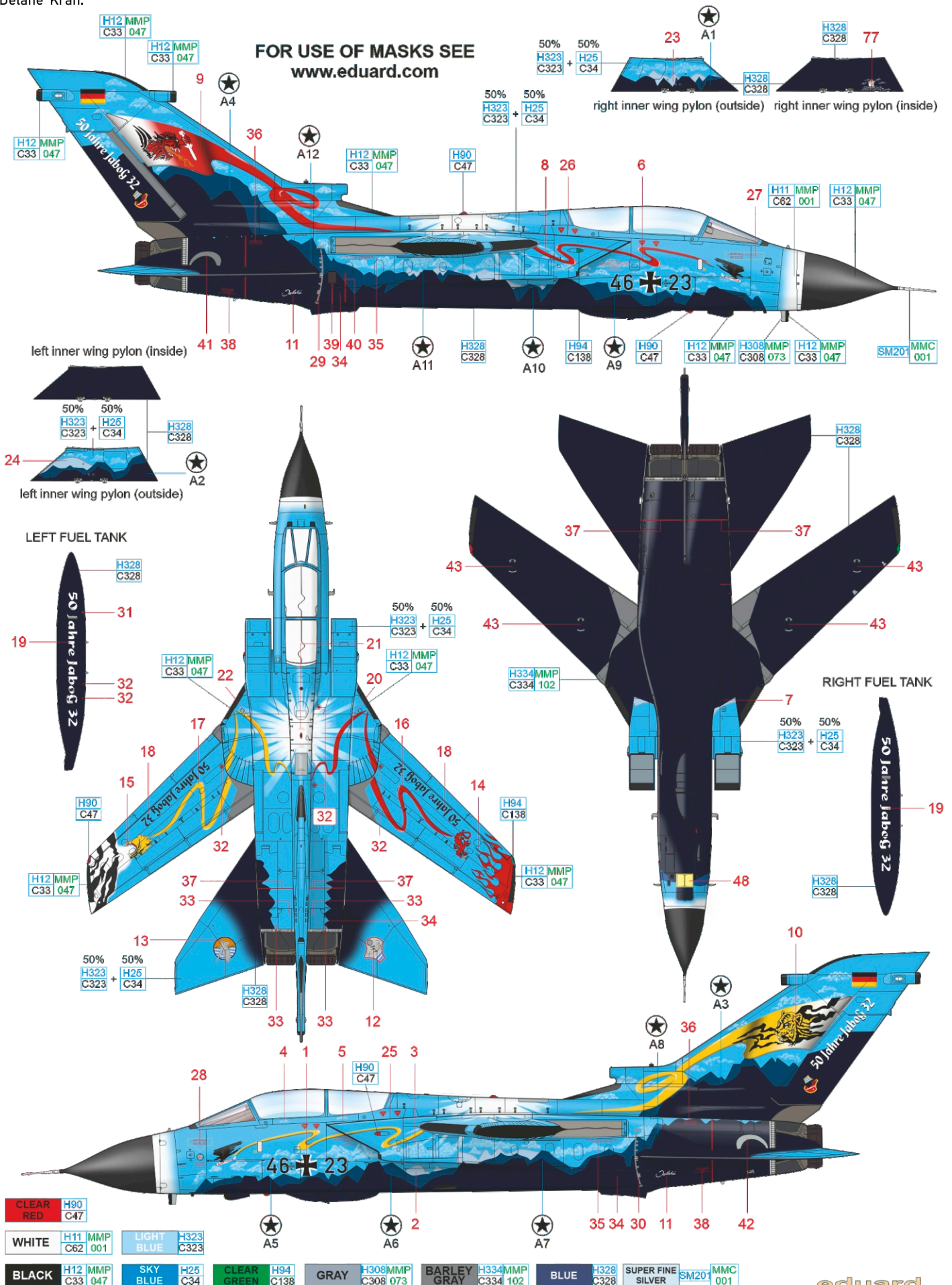

B 46+44, 1./JaboG 32, letecká základna Lechfeld, Německo, červen 2001

1. Staffel Jagdbombergeschwader 32, pojmenovaná Die Tigers (Tygři), byla k NATO Tiger Association přijata na zkoušku v roce 1994. Toto sdružení vzniklo v roce 1961 a jeho úkolem je podpora solidarity mezi leteckými silami NATO. Každým rokem pořádá setkání tzv. Tiger Meets, během nichž probíhají také společná cvičení jednotek. V roce 2001 se konal Tiger Meet v belgickém Kleine Brogelu, na němž 1./JaboG 32 připravila Tornado ECR s označením 46+44 v působivém tygřím markingu.

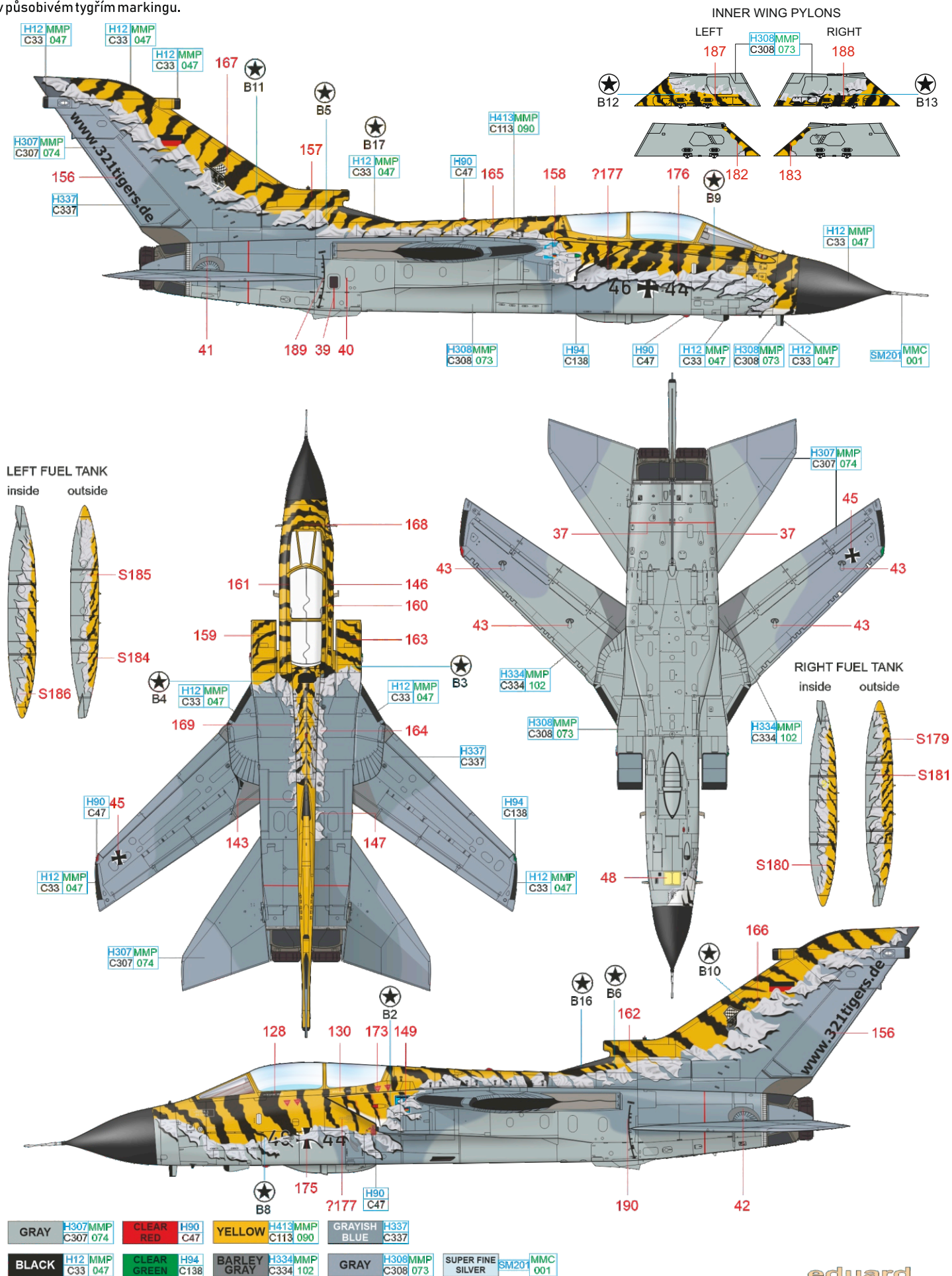

C 46+45, 2./JaboG 38 „Friesland“, Jever, Německo, červen 1993

Tornady ECR byly v německé Luftwaffe vyzbrojeny JaboG 32 a JaboG 38. Prvně jmenovaná jednotka sídlila na základně Lechfeld v Bavorsku. JaboG 38 naopak na severu dolnosaském Jeveru. Tato jednotka byla založena v srpnu 1983 a vyzbrojena víceúčelovými stroji Tornado IDS. Tornady ECR byla vybavena její 2. Staffel v roce 1989, používala je až do roku 1995, kdy byla Tornado v provedení ECR odeslána k JaboG 32. Dne 31. srpna 2005 byla JaboG 38 rozpuštěna.

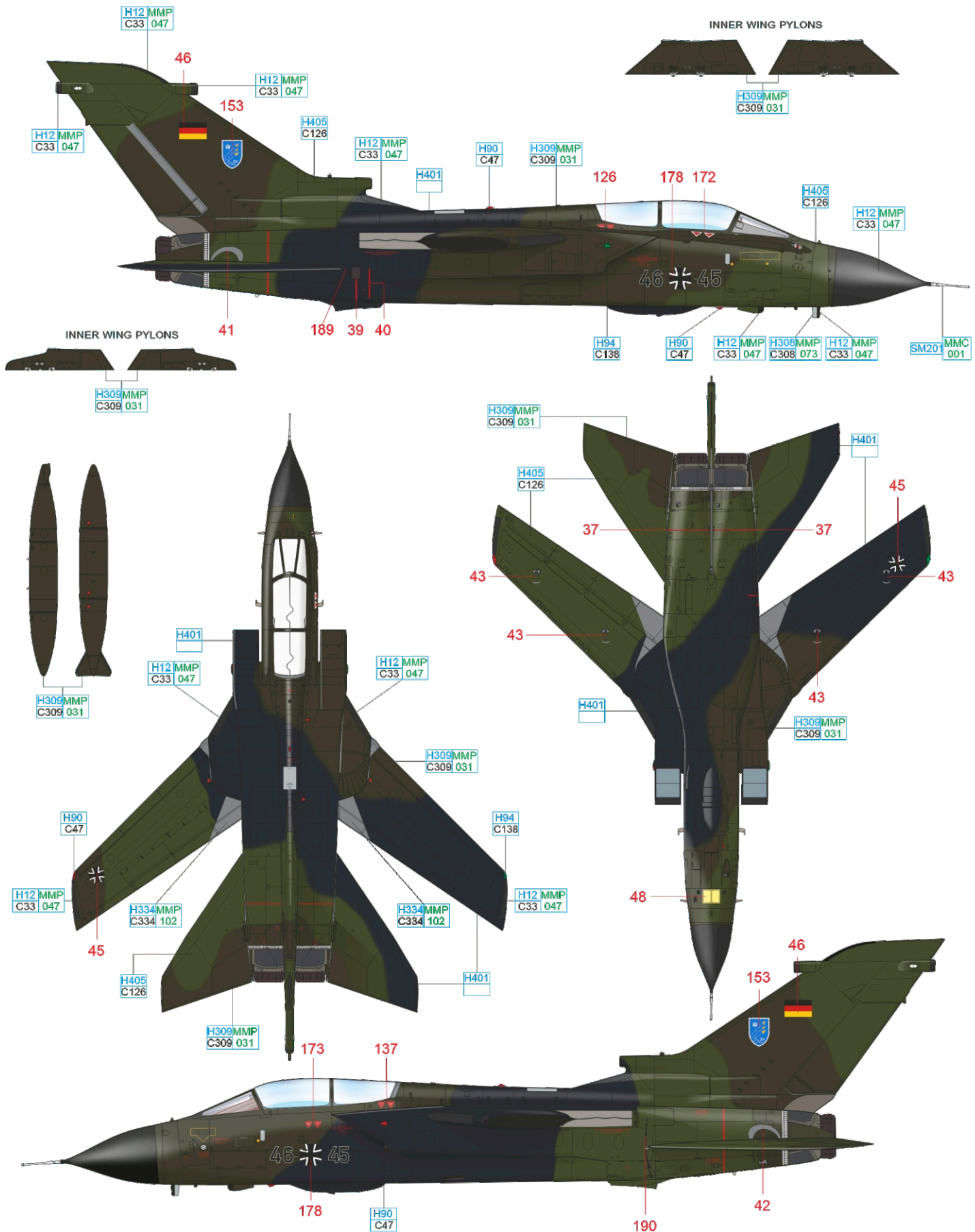

BARLEY GRAY	H334 MMP C334 102	GREEN	H309 MMP C309 031	CLEAR RED	H90 C47	DARK GRAY	H401
BLACK	H12 MMP C33 047	GRAY	H308 MMP C308 073	CLEAR GREEN	H94 C138	OLIVE GREEN	H405 C126
						SUPER FINE SILVER	SM201 MMC 001

D 46+54, TaktLwG 51 „Immelmann“, letecká základna Schleswig-Jagel, Německo, červenec 2017

Taktisches Luftwaffengeschwader 51 vznikla přejmenováním Aufklärungsgeschwader 51 dne 30. září 2013. Tato jednotka, vybavená Tornady IDS a ECR, sídlí na šlesvicko-holštýnské základně Schleswig-Jagel. Kamufláž Tornada s označením 46+54, nastříkaná v tzv. Norm 95 třemi odstíny šedé barvy, byla z důvodu účasti na cvičení Tiger Meet 2017, pořádaném ve francouzském Landivisiau, doplněna o tygří pruhy na přídavných nádržích a směrovce, zatímco na kýlovce přibyla kresba kočkovité šelmy a nápis NATO TIGERS.

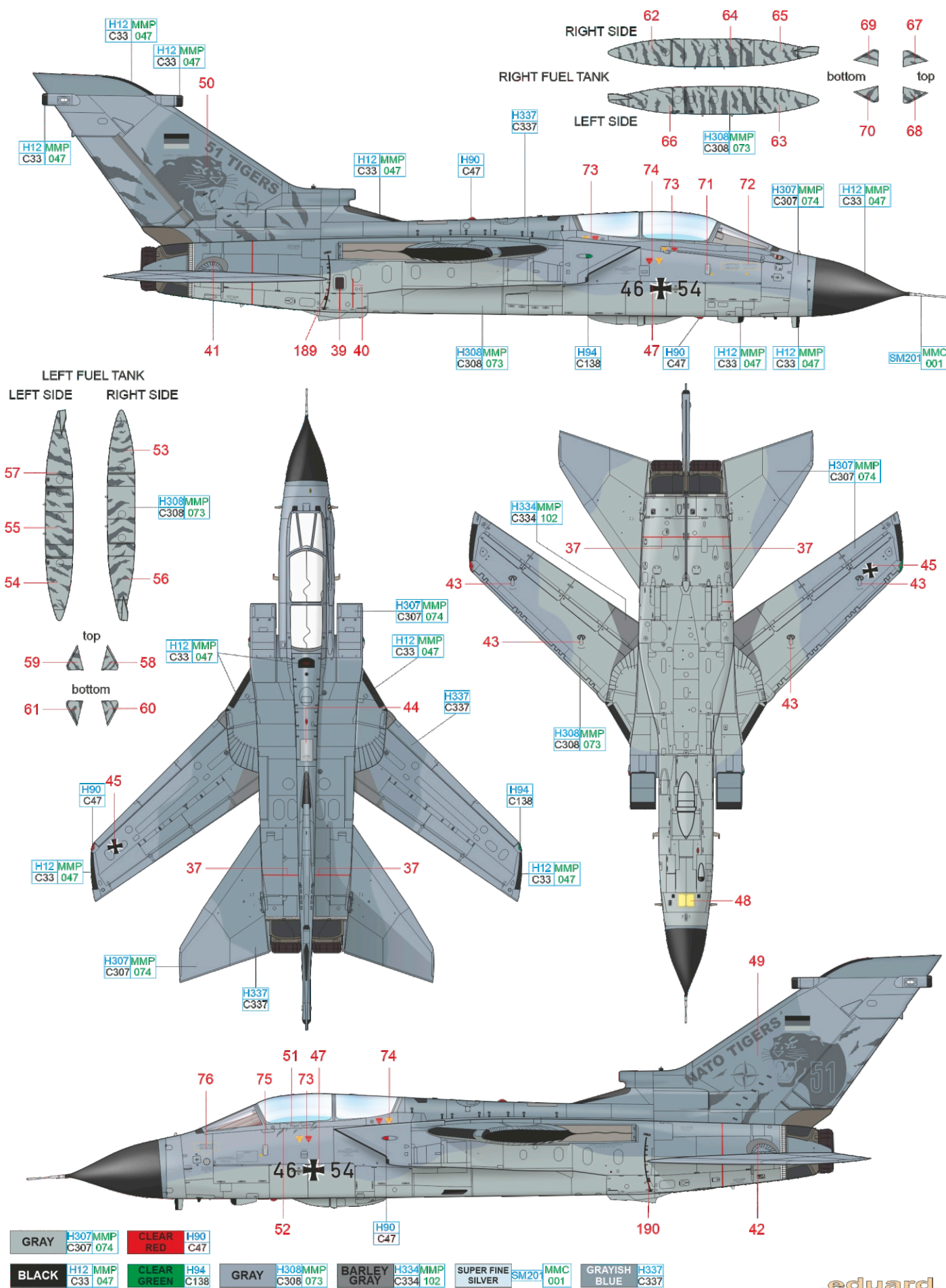

E 46+57, AG 51, letecká základna Schleswig-Jagel, Německo, červenec 2013

Aufklärungsgeschwader 51, předchůdce TaktLwG 51, byla znovuoobnovena v lednu 1994. Předchozí AG 51 byla společně se sesterskou AG 52 (obě byly vyzbrojeny průzkumnými RF-4E) rozpuštěna v polovině roku 1993. Nově vzniklá AG 51 obdržela Tornada IDS doplněná o verzi ECR. Takto zbarvené Tornado ECR se představilo na setkání Tiger Meet 2013 konaném v norském Ørlandu, kde AG 51 získala cenu Silver Tiger Trophy.

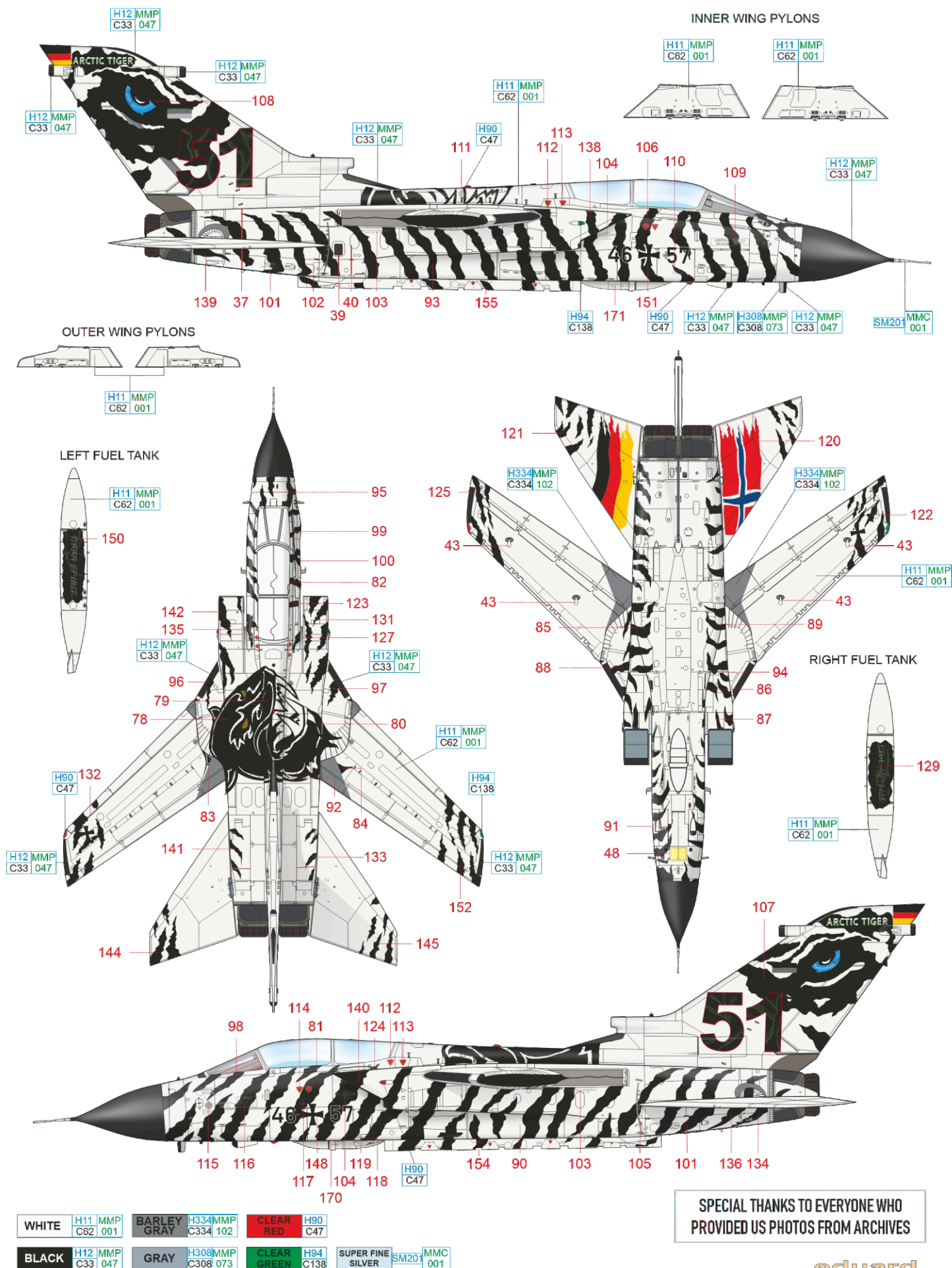

- 644136 Tornado ECR LööK (Brassin)
- 648029 AIM-9M/L (Brassin)
- 648095 GBU-24 (Brassin)
- 648180 AGM-88 HARM (Brassin)
- 648207 IRIS-T (Brassin)
- 648527 BOZ-EC pod (Brassin)
- 648564 GBU-54 (Brassin)
- 648715 TSPJ pod PRINT (Brassin)
- 3DL48056 Tornado ECR SPACE (3D Decal Set)
- EX824 Tornado ECR TFace (Mask)

Cat. No. 648207

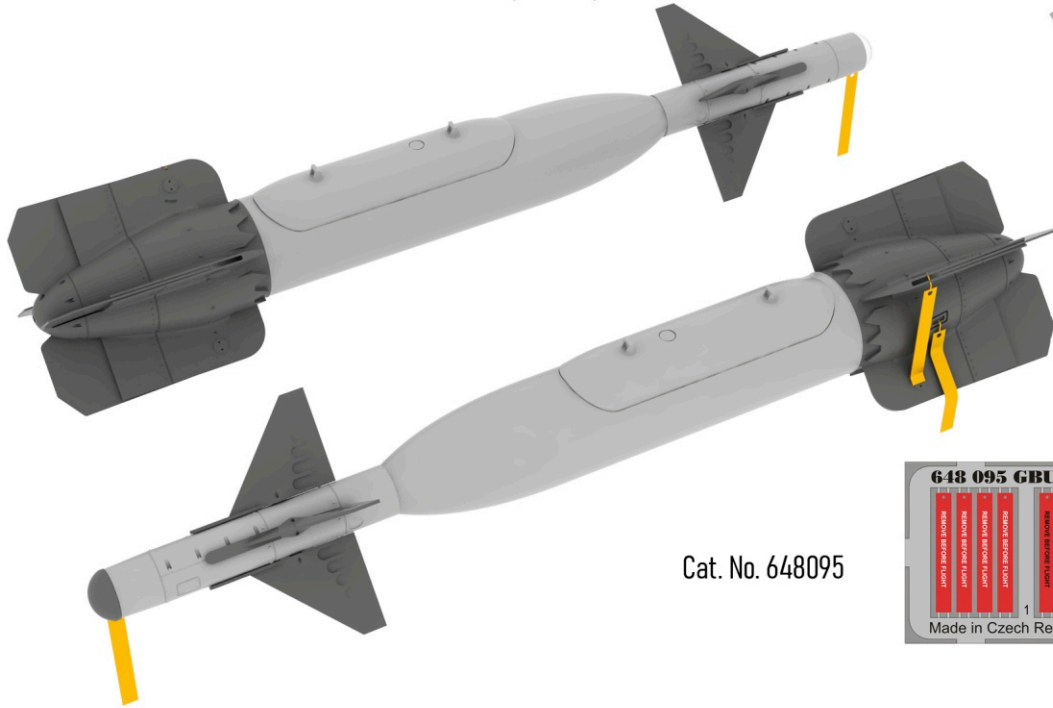
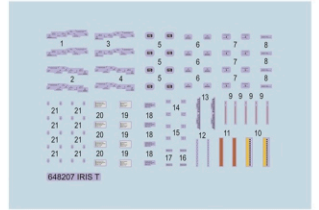

Cat. No. 648095

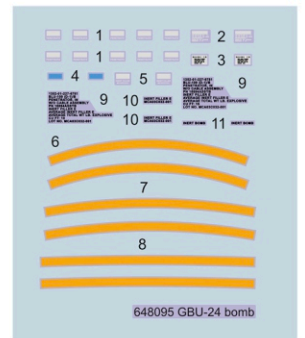
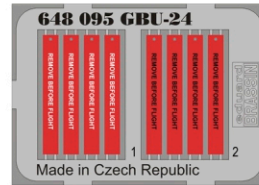

Cat. No. 648095

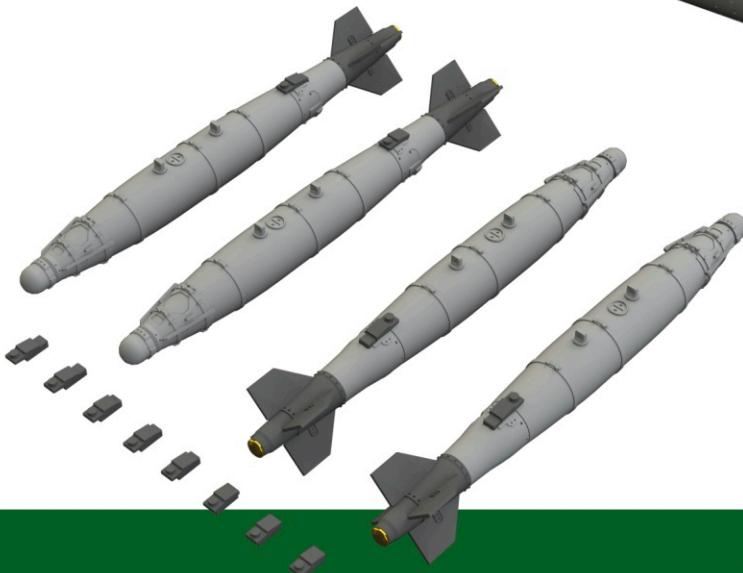
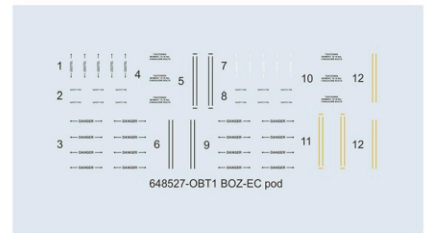
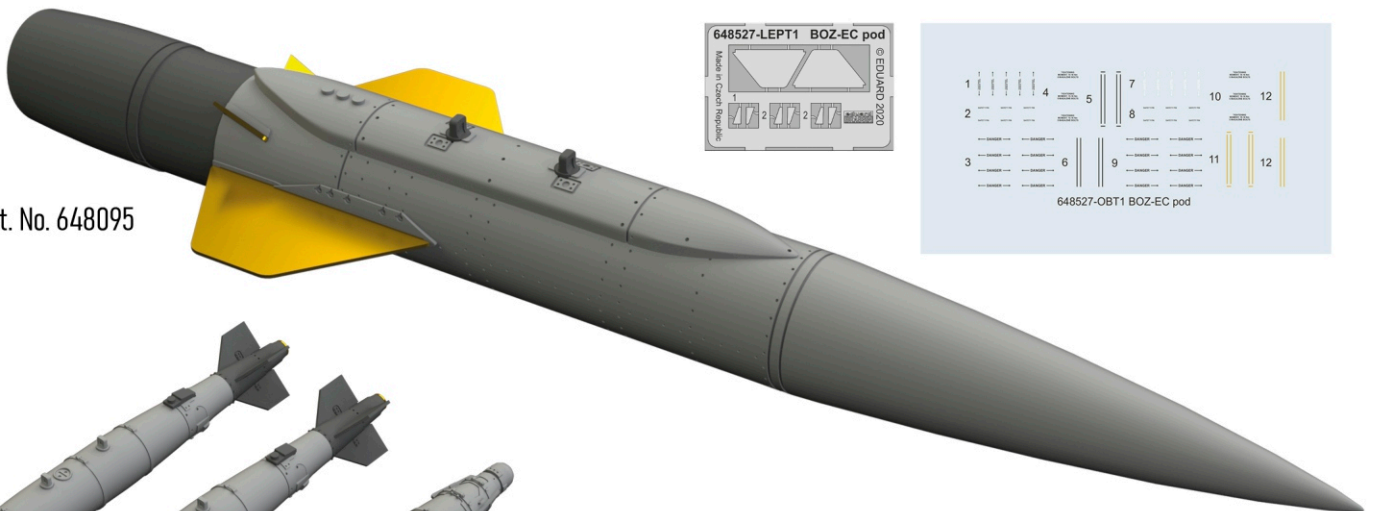

Cat. No. 648564

